

IMMINGHAM EASTERN RO-RO TERMINAL



Engineering Sections Drawings and Plans

Document 2.6

APFP Regulations 2009 – Regulation 5(2)(o)

PINS Reference – TR030007

November 2023

Document Information

Document Information	
Project	Immingham Eastern Ro-Ro Terminal
Document title	Engineering Sections Drawings and Plans
Commissioned by	Associated British Ports
Document ref	2.6
APFP Regs	5(2)(o)
Prepared by	ABP Project Team

Date	Version	Revision Details
02/2023	01 Submission	N/A
03/2023	02 Version 2	PINS S51 Advice
11/2023	03 Changes Application	Changes Application

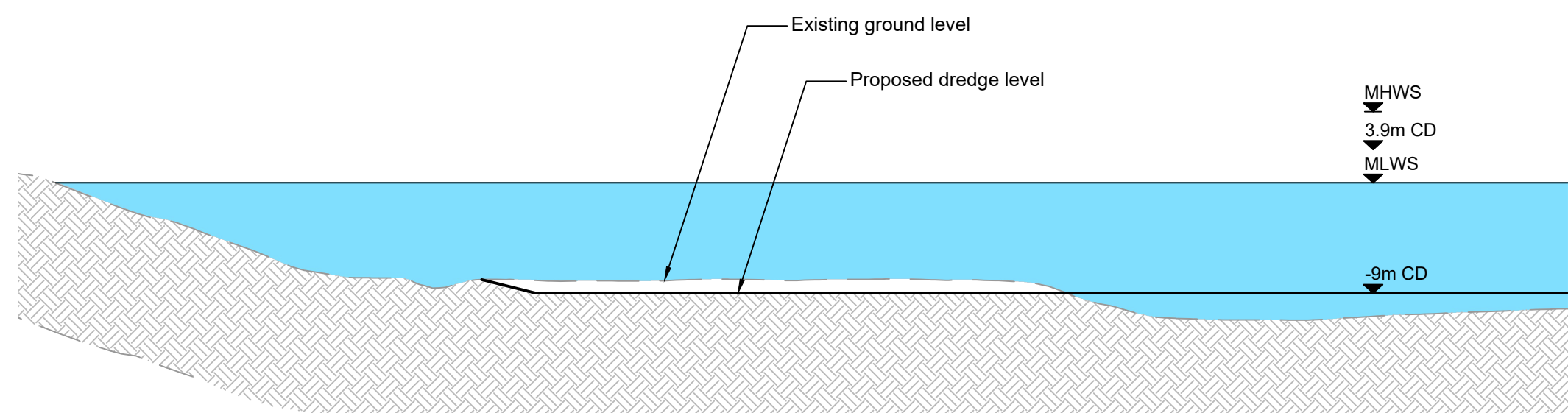
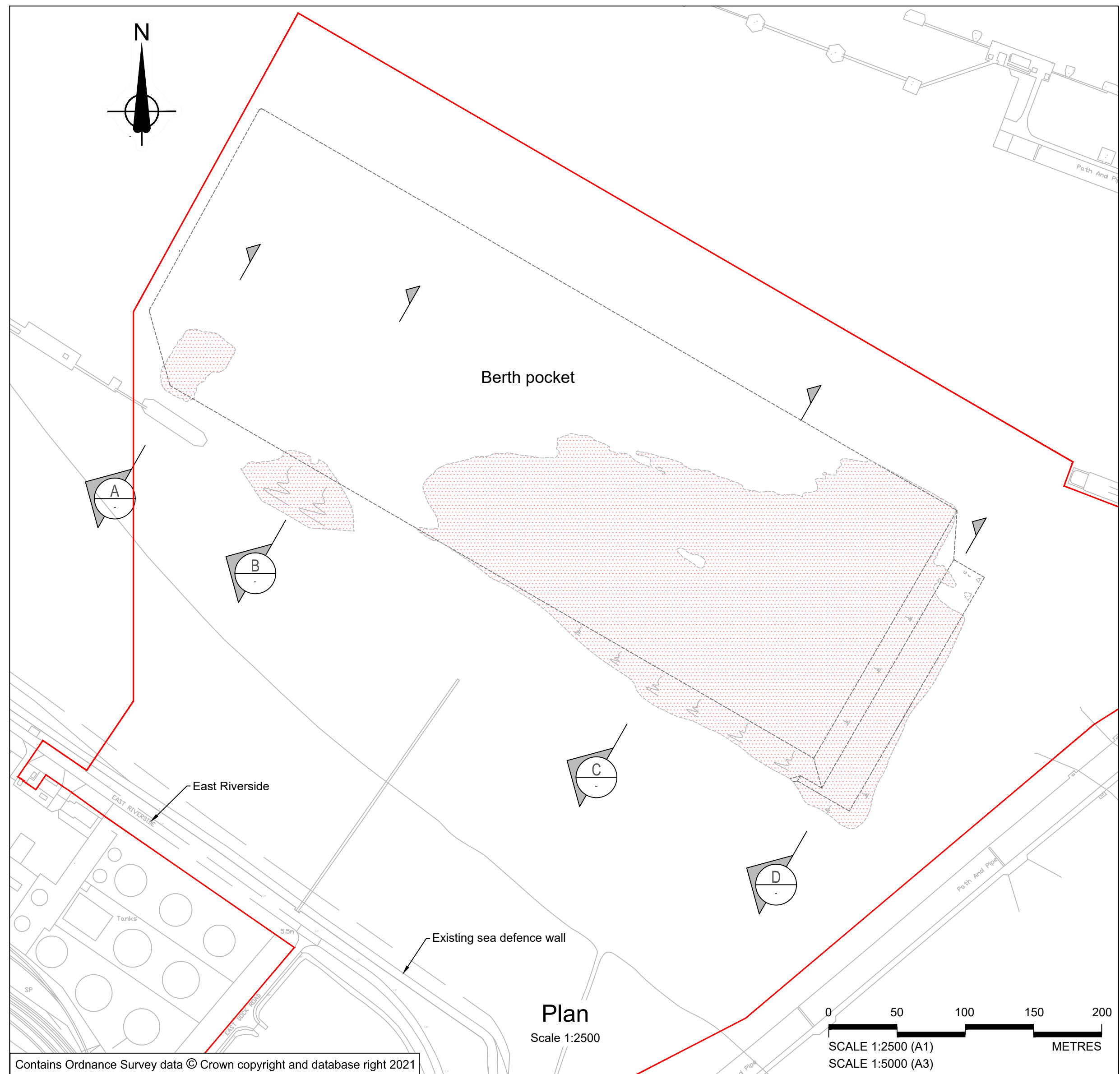

Work No. 2 - Section A-A
Scale 1:500

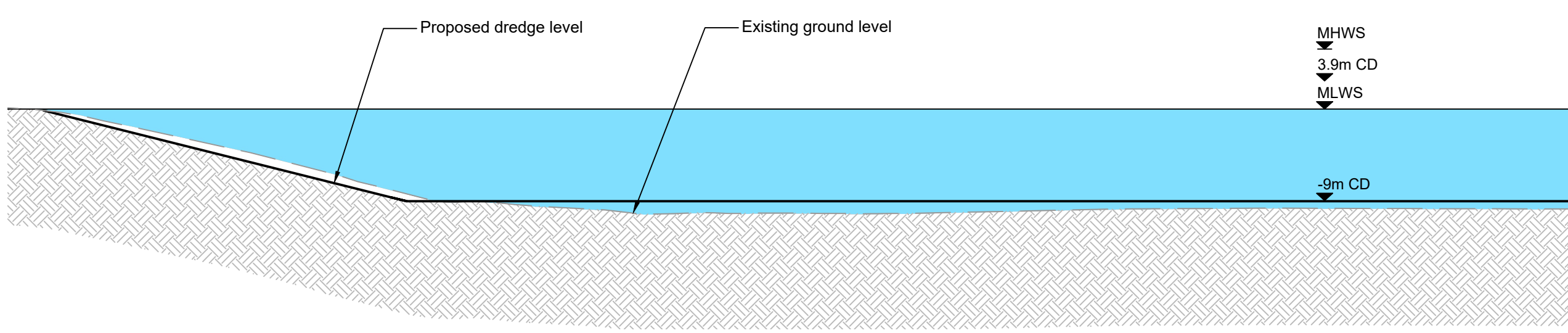

Work No. 2 - Section B-B
Scale 1:500

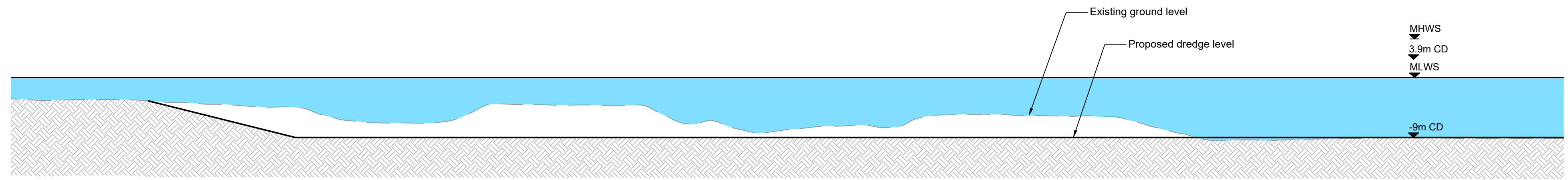

Work No. 2 - Section C-C
Scale 1:500

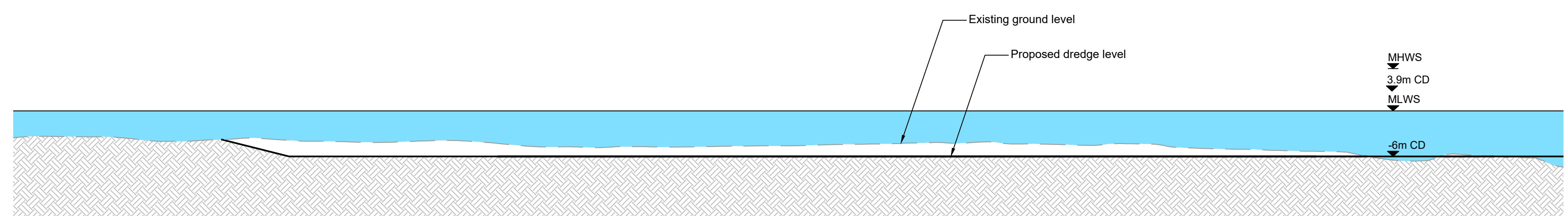

Work No. 2 - Section D-D
Scale 1:500

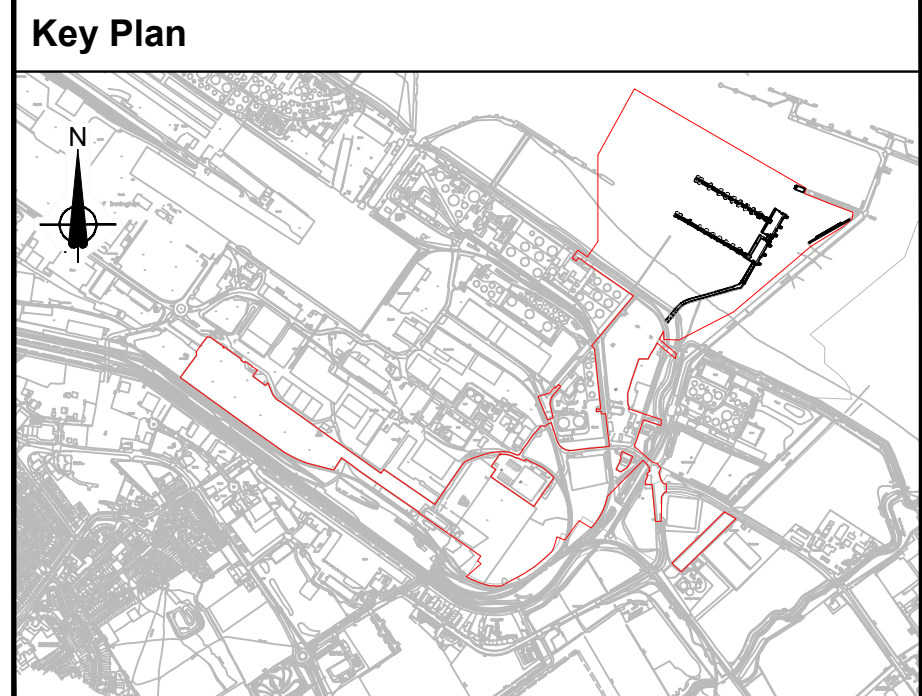
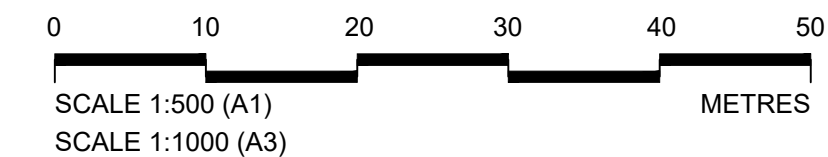

- General Notes**
- All dimensions are in metres unless noted otherwise.
 - These engineering sections and plans should be read in conjunction with the key plan and alongside other plans in the development consent order application. In particular the works plan and Schedule 1 (Authorised Development) to the development consent order.
 - Work No. references are detailed in Schedule 1 (Authorised Development) to the development consent order.
 - These engineering sections and plans will be subject to detailed design development; and changes will be limited to being within the order limits and any other constraints included in the development consent order.
 - Location of proposed infrastructure shown indicatively.
 - The relationship between ordnance datum and chart datum refer to the diagram below:

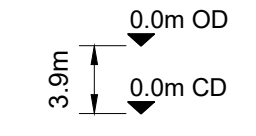

- Legend**
- Order Limits (Red line)
 - Proposed extents of dredging (Dotted pattern)
 - Existing sea bed (Hatched pattern)
 - Tidal water (Blue area)

P05	November 2023	Changes Application Version	TH	RH	RH	CN
P04	October 2023	For Consultation	DT	RH	RH	CN
P03	August 2023	Client review	DT	ID	RH	CN
P02.1	September 2023	Deadline 4 submission	DT	RH	RH	CN
P02	February 2023	Submission Version	AJM	RH	RH	CN
P01	January 2023	Submission Version	AJM	RH	RH	CN
Rev	Rev. Date	Purpose of revision	Orig	Check	Rev	Apprv

Jacobs
95 Bothwell St, Glasgow, G2 7HX
Tel: +44(0)141 243 8000 Fax: +44(0)141 226 3109
www.jacobs.com

Client
ABP | ASSOCIATED BRITISH PORTS

Project
IMMINGHAM EASTERN
RO-RO TERMINAL

Drawing title
**ENGINEERING SECTIONS & PLANS
ILLUSTRATIVE CROSS SECTIONS
EXTENT AND DEPTH OF DREDGING
REGULATION 5(2)(o)**

Drawing status
CHANGES APPLICATION VERSION **S4**

Scale
AS SHOWN @ A1

Jacobs No.
B2429400

Client No.
P05

Drawing number
B2429400-JAC-00-ZZ-DR-ZZ-0711

\\uksp02\maritime\PROJECTS\Ports\VT\B2429400-ABP-Project\Sugar\1100-Design-Engineering\1102-Drawings\01-Preliminary\02-DCO-Drawings\B2429400-JAC-00-ZZ-DR-ZZ-0711-P05.dwg - 23/11/2023 18:31:37 - 0711 - HodgeT

© Copyright 2022 Jacobs U.K. Limited. The concepts and information contained in this document are the property of Jacobs. Use or copying of this document in whole or in part without the written permission of Jacobs constitutes an infringement of copyright. Limitation: This drawing has been prepared on behalf of, and for the exclusive use of, Jacobs' Client, and is subject to, and issued in accordance with, the provisions of the contract between Jacobs and the Client. Jacobs accepts no liability or responsibility whatsoever for, or in respect of, any use of, or reliance upon, this drawing by any third party.

\\ukfspp02\Maritime\PROJECTS\Ports\VT\B2429400-ABP Project\Sugar\1100 Design & Engineering\1102 Drawings\01 Preliminary\02 DCO Drawings\B2429400-JAC-00-ZZ-DR-ZZ-0720 P05.dwg - 27/11/2023 10:42:58 - 0720 - HillsRJ

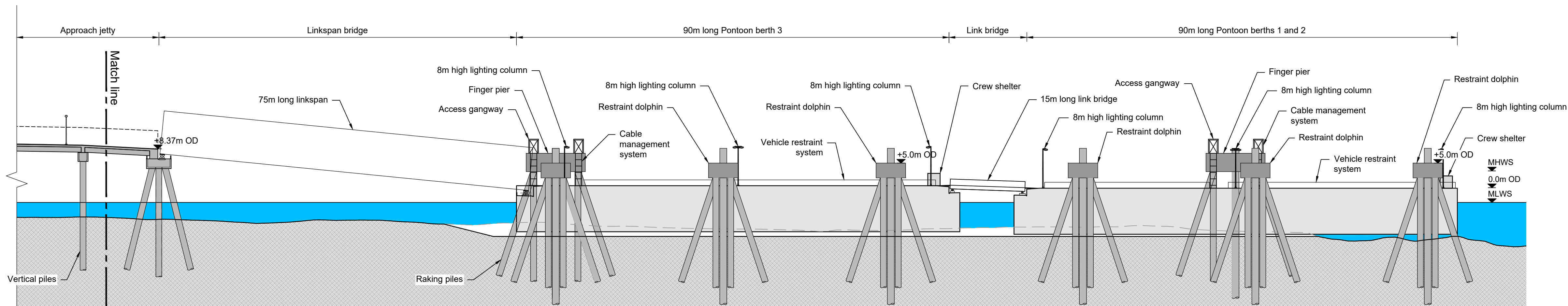
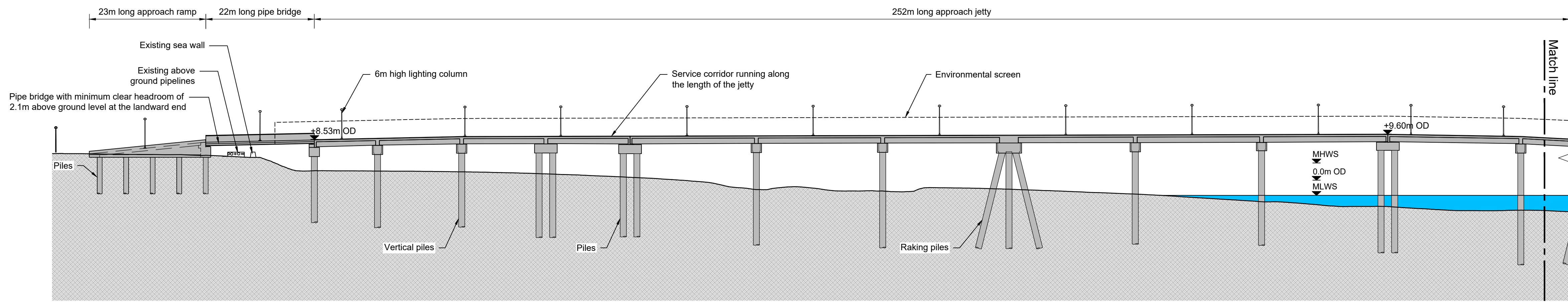

Work No. 1 and 2 - Section E-E
Scale 1:500

Key Plan

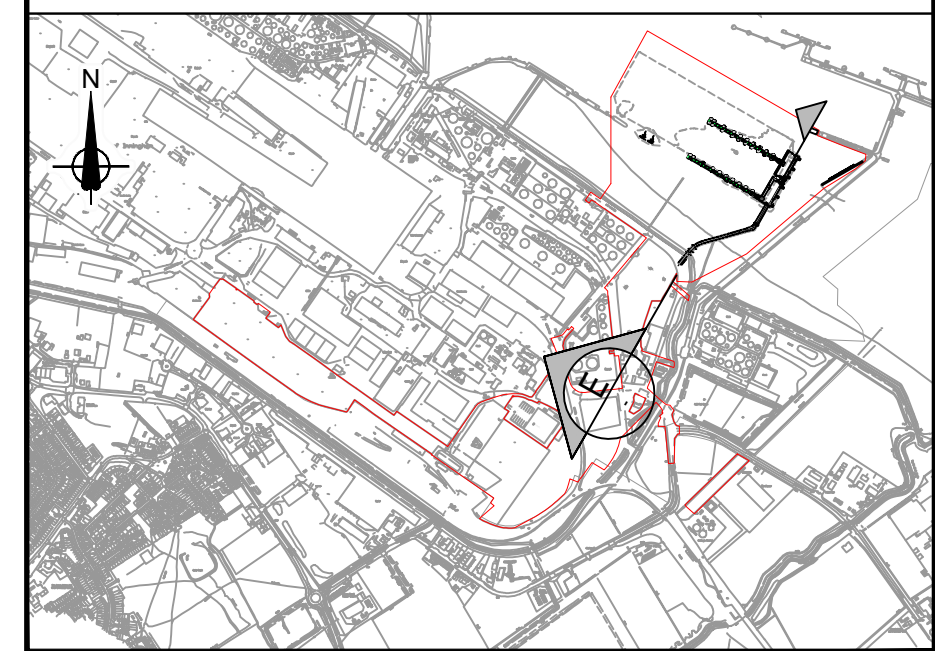

General Notes

- All dimensions are in metres unless noted otherwise.
- These engineering sections and plans should be read in conjunction with the key plan and alongside other plans in the development consent order application. In particular the works plan and Schedule 1 (Authorised Development) to the development consent order.
- Work No. references are detailed in Schedule 1 (Authorised Development) to the development consent order.
- These engineering sections and plans will be subject to detailed design development; and changes will be limited to being within the order limits and any other constraints included in the development consent order.
- Location of proposed infrastructure shown indicatively.
- Pile lengths show for illustrative purposes only and will be subject detailed design development.

Legend

- Order Limits
- Existing sea bed
- Tidal water

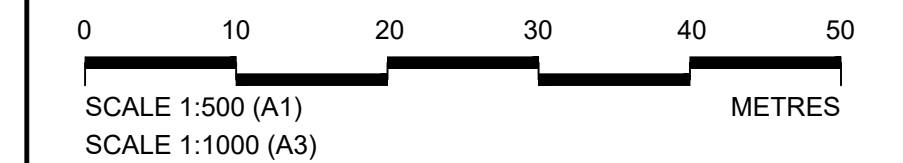

P05	November 2023	Changes Application Version	TH	RH	RH	CN
P04	October 2023	For Consultation	AE	RH	RH	CN
P03	August 2023	Client review	DT	ID	RH	CN
P02.1	September 2023	Deadline 4 submission	DT	RH	RH	CN
P02	February 2023	Submission Version	AJM	RH	RH	CN
P01	January 2023	Submission Version	AJM	RH	RH	CN
Rev	Rev. Date	Purpose of revision	Orig	Check	Rev	Apprv

Jacobs

95 Bothwell St, Glasgow, G2 7HX
Tel: +44(0)141 243 8000 Fax: +44(0)141 226 3109
www.jacobs.com



Client
**IMMINGHAM EASTERN
RO-RO TERMINAL**

Drawing title
**ENGINEERING SECTIONS & PLANS
ILLUSTRATIVE CROSS SECTIONS
RORO BERTHS
REGULATION 5(2)(o)**

Drawing status	CHANGES APPLICATION VERSION	Suitability	S4
Scale	AS SHOWN @ A1	Jacobs No.	B2429400
Client No.		Rev	P04

Drawing number
B2429400-JAC-00-ZZ-DR-ZZ-0720

© Copyright 2022 Jacobs U.K. Limited. The concepts and information contained in this document are the property of Jacobs. Use or copying of this document in whole or in part without the written permission of Jacobs constitutes an infringement of copyright. Limitation: This drawing has been prepared on behalf of, and for the exclusive use of, Jacobs' Client, and is subject to, and issued in accordance with, the provisions of the contract between Jacobs and the Client. Jacobs accepts no liability or responsibility whatsoever for, or in respect of, any use of, or reliance upon, this drawing by any third party.

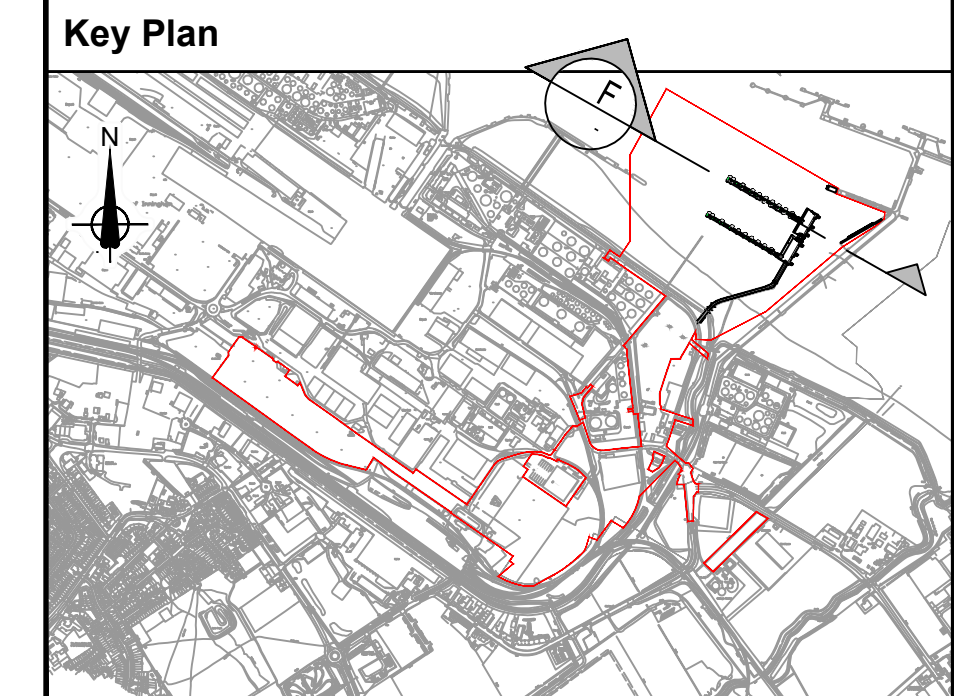
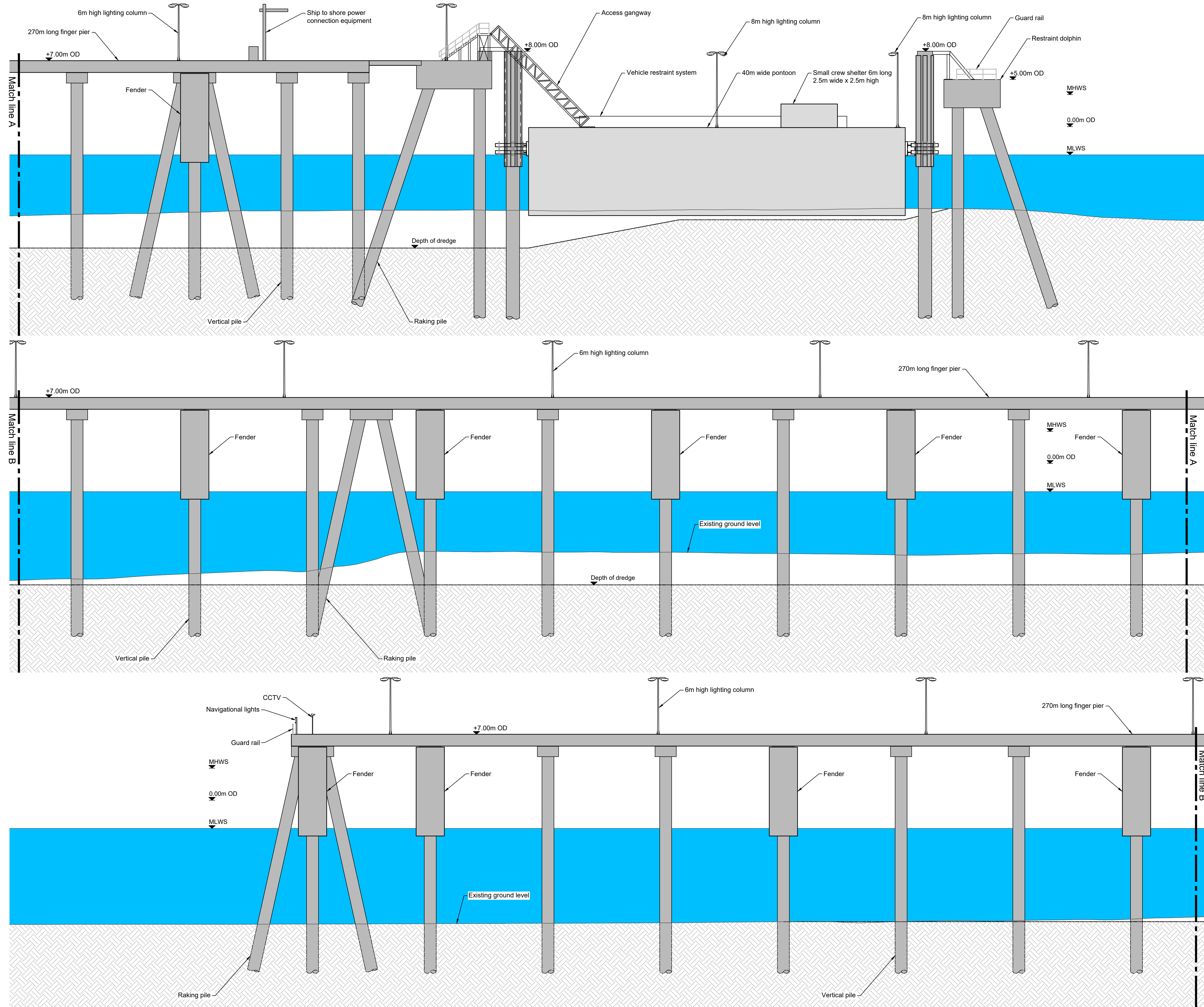

- General Notes**
- All dimensions are in metres unless noted otherwise.
 - These engineering sections and plans should be read in conjunction with the key plan and alongside other plans in the development consent order application. In particular the works plan and Schedule 1 (Authorised Development) to the development consent order.
 - Work No. references are detailed in Schedule 1 (Authorised Development) to the development consent order.
 - These engineering sections and plans will be subject to detailed design development; and changes will be limited to being within the order limits and any other constraints included in the development consent order.
 - Location of proposed infrastructure shown indicatively.
 - Pile lengths show for illustrative purposes only and will be subject detailed design development

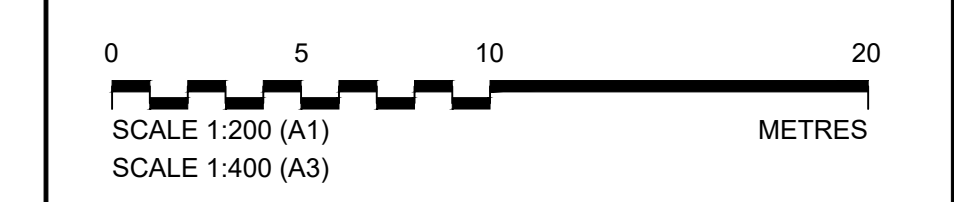
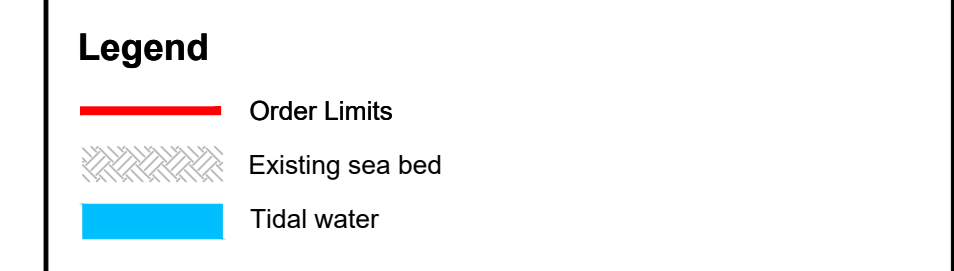

P05	November 2023	Changes Application Version	TH	RH	RH	CN
P04	October 2023	For Consultation	AE	RH	RH	CN
P03	August 2023	Client review	DT	ID	RH	CN
P02.1	September 2023	Deadline 4 submission	DT	RH	RH	CN
P02	February 2023	Submission Version	AJM	RH	RH	CN
P01	January 2023	Submission Version	AJM	RH	RH	CN
Rev	Rev. Date	Purpose of revision	Orig	Check	Rev	Aprv

Jacobs
 95 Bothwell St, Glasgow, G2 7HX
 Tel:+44(0)141 243 8000 Fax:+44(0)141 226 3109
 www.jacobs.com

Client
ABP ASSOCIATED BRITISH PORTS

Project
 IMMINGHAM EASTERN RO-RO TERMINAL

Drawing title
ENGINEERING SECTION & PLANS ILLUSTRATIVE CROSS SECTIONS FINGER PIERS REGULATION 5(2)(o)

Drawing status	CHANGES APPLICATION VERSION	Suitability	S4
Scale	AS SHOWN @ A1		
Jacobs No.	B2429400	Rev	P05
Client No.			

Drawing number
B2429400-JAC-00-ZZ-DR-ZZ-0722

© Copyright 2022 Jacobs U.K. Limited. The concepts and information contained in this document are the property of Jacobs. Use or copying of this document in whole or in part without the written permission of Jacobs constitutes an infringement of copyright. Limitation. This drawing has been prepared on behalf of, and for the exclusive use of, the Client. Jacobs accepts no liability or responsibility whatsoever for, or in respect of, any use of, or reliance upon, this drawing by any third party.

\\ukfsp02\maritime\PROJECTS\Ports\VT\B2429400-ABP-Project\Sugar\1102-Design & Engineering\1102-Drawings\01-Preliminary\02-DCO Drawings\B2429400-JAC-00-ZZ-DR-ZZ-0722-P05.dwg - 23/11/2023 09:59:30 - 0722 - HodgeT

Work No. 1 & 2 - Section F-F
 Scale 1:200

\\uksp02\maritime\PROJECTS\Ports\VT\B2429400-ABP-Project\Sugar\1100-Design & Engineering\1102-Drawings\01-Preliminary\02-DCO Drawings\B2429400-JAC-00-ZZ-DR-ZZ-0723-P04.dwg - 23/11/2023 10:03:59 - 0723 - HodgeT

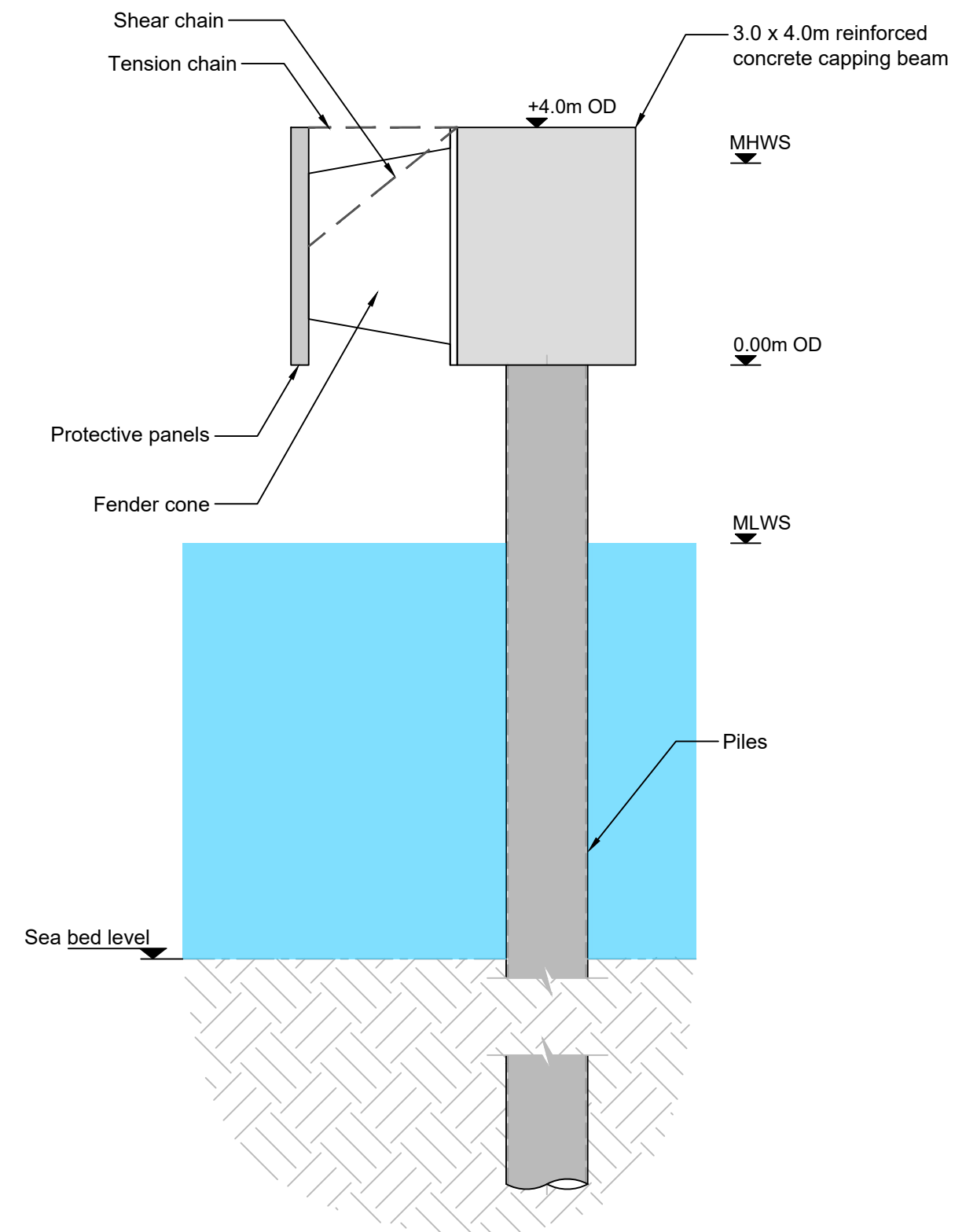

Work No. 3 - Section H-H
Scale 1:100

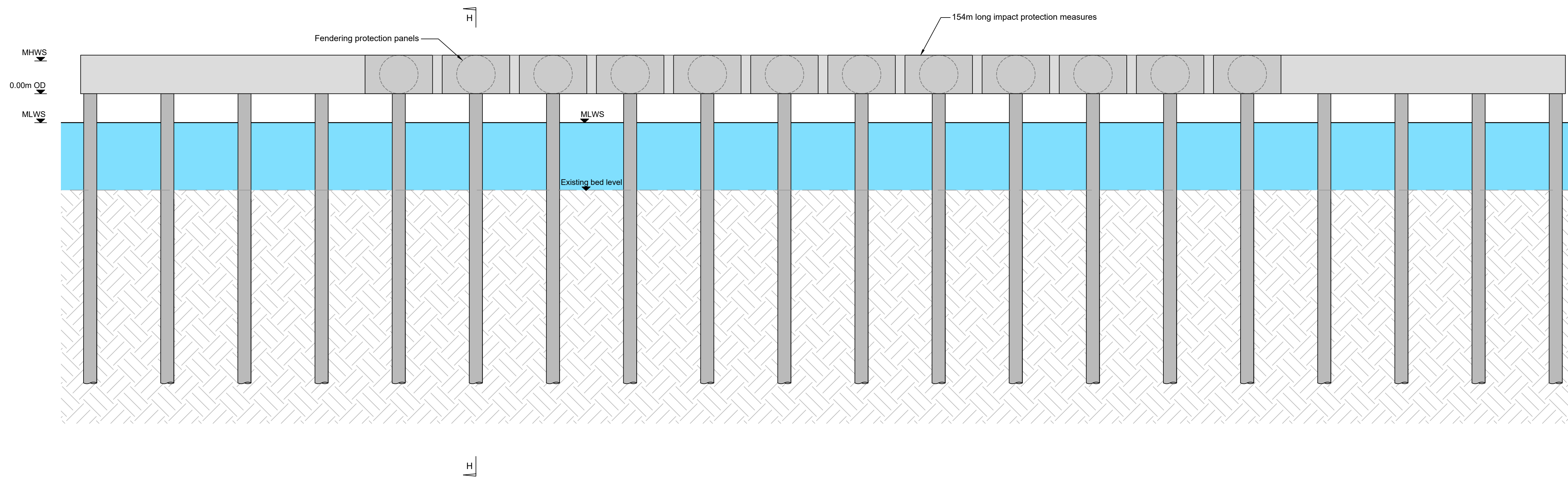

Work No. 3 - Section G-G
Scale 1:250

Key Plan

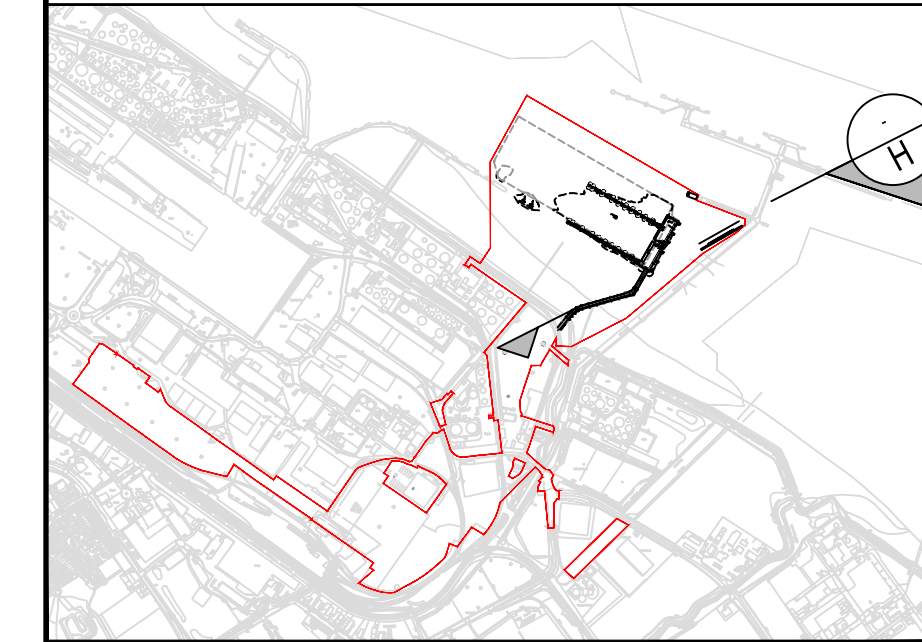

General Notes:

1. All dimensions are in metres unless otherwise stated.
2. Numbered works are references to works in schedule 1 (Authorised Development) to the Development Consent Order.
3. The works will be subject to Detailed Design Development in accordance with the Development Consent Order.
4. These works plans should be read in conjunction with the Engineering Sections and Plans. The Development Consent Order provides for vertical deviation with reference to the levels of the works shown on the Engineering Sections and Plans.
5. Location of proposed infrastructure shown indicatively.
6. Pile lengths show for illustrative purposes only and will be subject detailed design development

Legend

- Order Limits
- Existing sea bed
- Tidal water

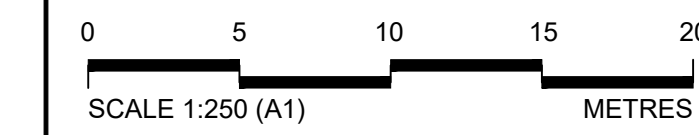

Rev	Rev. Date	Purpose of revision	Orig	Check	Rev	Apprv
PD4	November 2023	Changes Application Version	TH	RH	RH	CN
P03	October 2023	For Consultation	AE	RH	RH	CN
P02.1	September 2023	Deadline 4 submission	DT	RH	RH	CN
P02	February 2023	Submission Version	AJM	RH	RH	CN
P01	January 2023	Submission Version	AJM	RH	RH	CN

Jacobs

95 Bothwell St. Glasgow, G2 7HX
Tel:+44(0)141 243 8000 Fax:+44(0)141 226 3109
www.jacobs.com

Client



Project

IMMINGHAM EASTERN
RO-RO TERMINAL

Drawing title

ENGINEERING SECTIONS & PLANS
ILLUSTRATIVE CROSS SECTIONS
TRUNKWAY IMPACT PROTECTION
MEASURES REGULATION 5(2)(c)

Drawing status

CHANGES APPLICATION VERSION

Suitability

S4

Scale

AS SHOWN @ A1

Jacobs No.

B2429400

Client No.

P04

Drawing number

B2429400-JAC-00-ZZ-DR-ZZ-0723

© Copyright 2022 Jacobs U.K. Limited. The concepts and information contained in this document are the property of Jacobs. Use or copying of this document in whole or in part without the written permission of Jacobs constitutes an infringement of copyright. Limitation: This drawing has been prepared on behalf of, and for the exclusive use of, the Client, and is subject to, and issued in accordance with, the provisions of the contract between Jacobs and the Client. Jacobs accepts no liability or responsibility whatsoever for, or in respect of, any use of, or reliance upon, this drawing by any third party.

\\ukfspp02\Maritime\PROJECTS\Ports\VT\B2429400-ABP-Project\Sugar\1100-Design-Engineering\1102-Drawings\02-DCO Drawings\01-Preliminary\02-DCO Drawings\B2429400-JAC-00-ZZ-DR-ZZ-0724-P03.dwg - 27/11/2023 10:35:18 - 0724 - HillsRJ

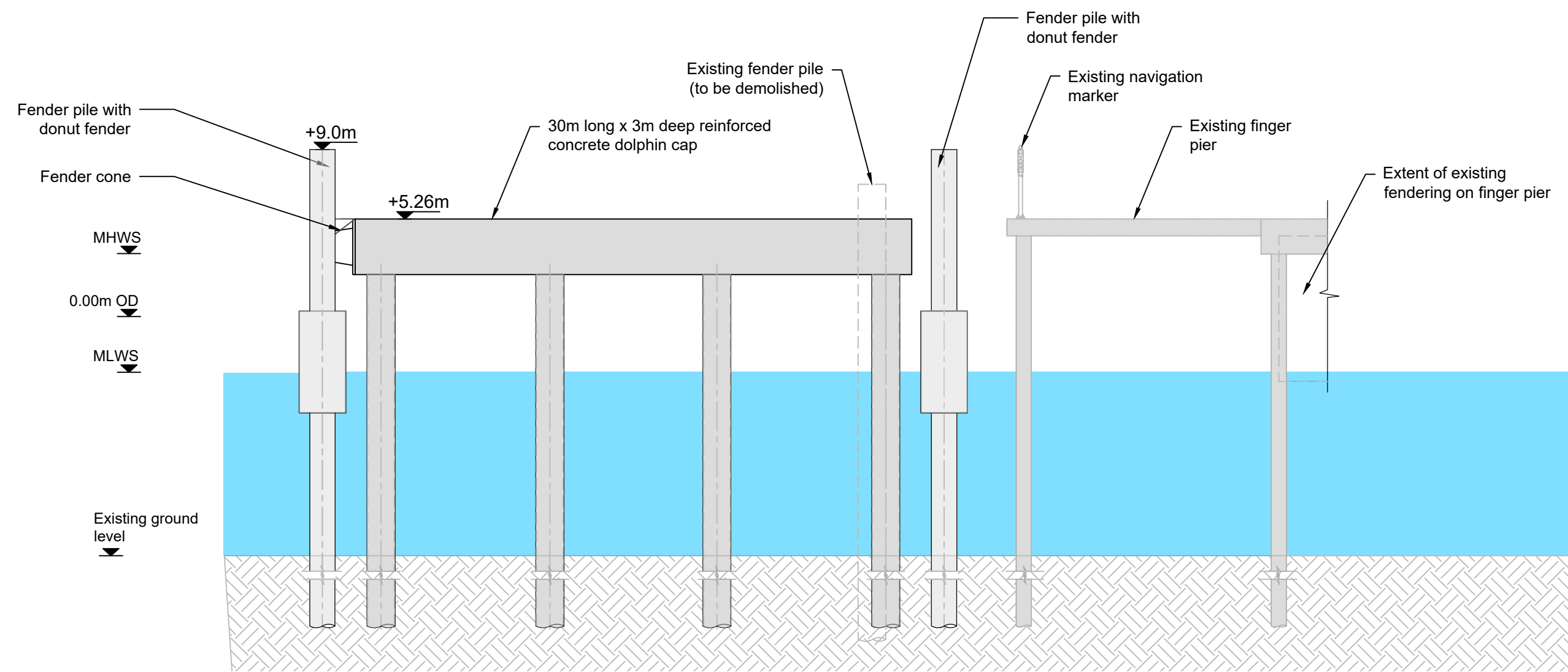

Work No. 3 - Section K-K
Scale 1:250

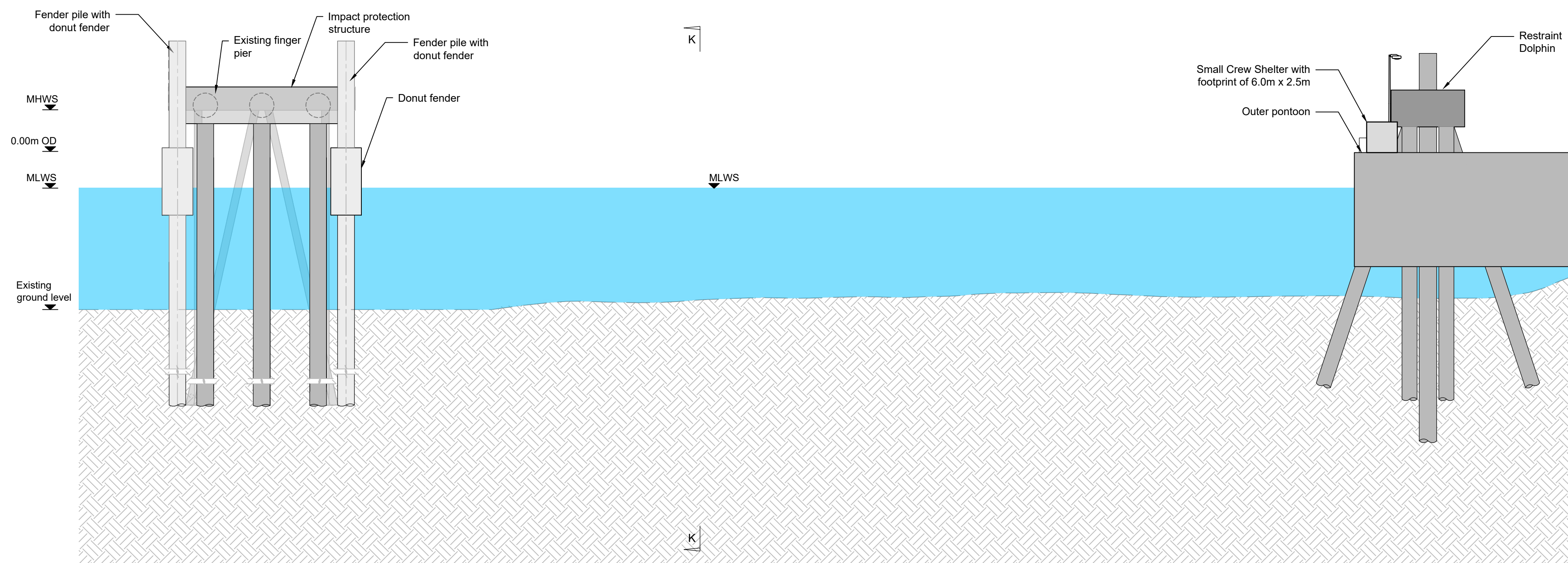

Work No. 3 - Section J-J
Scale 1:250

Key Plan

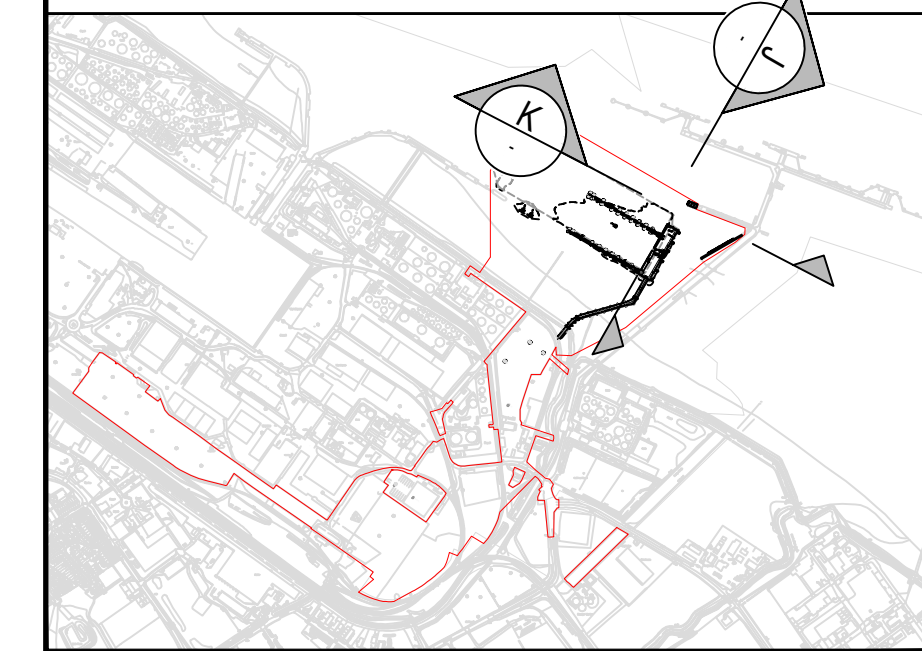

General Notes:

- All dimensions are in metres unless otherwise stated.
- Numbered works are references to works in schedule 1 (Authorised Development) to the Development Consent Order.
- The works will be subject to Detailed Design Development in accordance with the Development Consent Order.
- These works plans should be read in conjunction with the Engineering Sections and Plans. The Development Consent Order provides for vertical deviation with reference to the levels of the works shown on the Engineering Sections and Plans.
- Location of proposed infrastructure shown indicatively
- Pile lengths show for illustrative purposes only and will be subject detailed design development.

Legend

- Order Limits
- Existing sea bed
- Tidal water

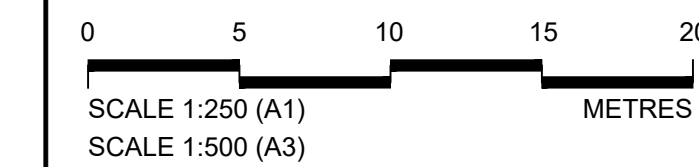

P03	November 2023	Changes Application Version	TH	RH	RH	CN
P02	October 2023	For Consultation	AE	RH	RH	CN
P01	October 2023	For Client review	AE	RH	RH	CN
Rev	Rev. Date	Purpose of revision	Orig	Check	Rev	Apprv

Jacobs

95 Bothwell St, Glasgow, G2 7HX
Tel: +44(0)141 243 8000 Fax: +44(0)141 226 3109
www.jacobs.com

Client
ABP ASSOCIATED BRITISH PORTS

Project
IMMINGHAM EASTERN RO-RO TERMINAL

Drawing title
ENGINEERING SECTIONS & PLANS ILLUSTRATIVE CROSS SECTIONS FINGER PIER IMPACT PROTECTION MEASURES REGULATION 5(2)(c)

Drawing status	CHANGES APPLICATION VERSION	Suitability	S4
Scale	AS SHOWN @ A1		
Jacobs No.	B2429400		
Client No.			Rev P03

Drawing number
B2429400-JAC-00-ZZ-DR-ZZ-0724

© Copyright 2022 Jacobs U.K. Limited. The concepts and information contained in this document are the property of Jacobs. Use or copying of this document in whole or in part without the written permission of Jacobs constitutes an infringement of copyright. Limitation: This drawing has been prepared on behalf of, and for the exclusive use of, the Client. Jacobs accepts no liability or responsibility whatsoever for, or in respect of, any use of, or reliance upon, this drawing by any third party.

\\ukfsp02\maritime\PROJECTS\Ports(VT)\B2429400-ABP-Project\Sugar\1100 Design & Engineering\1102 Drawings\02 DCO Drawings\B2429400-JAC-00-ZZ-DR-ZZ-0740 P05.dwg - 24/11/2023 16:46:09 - 0740 - HodgeT

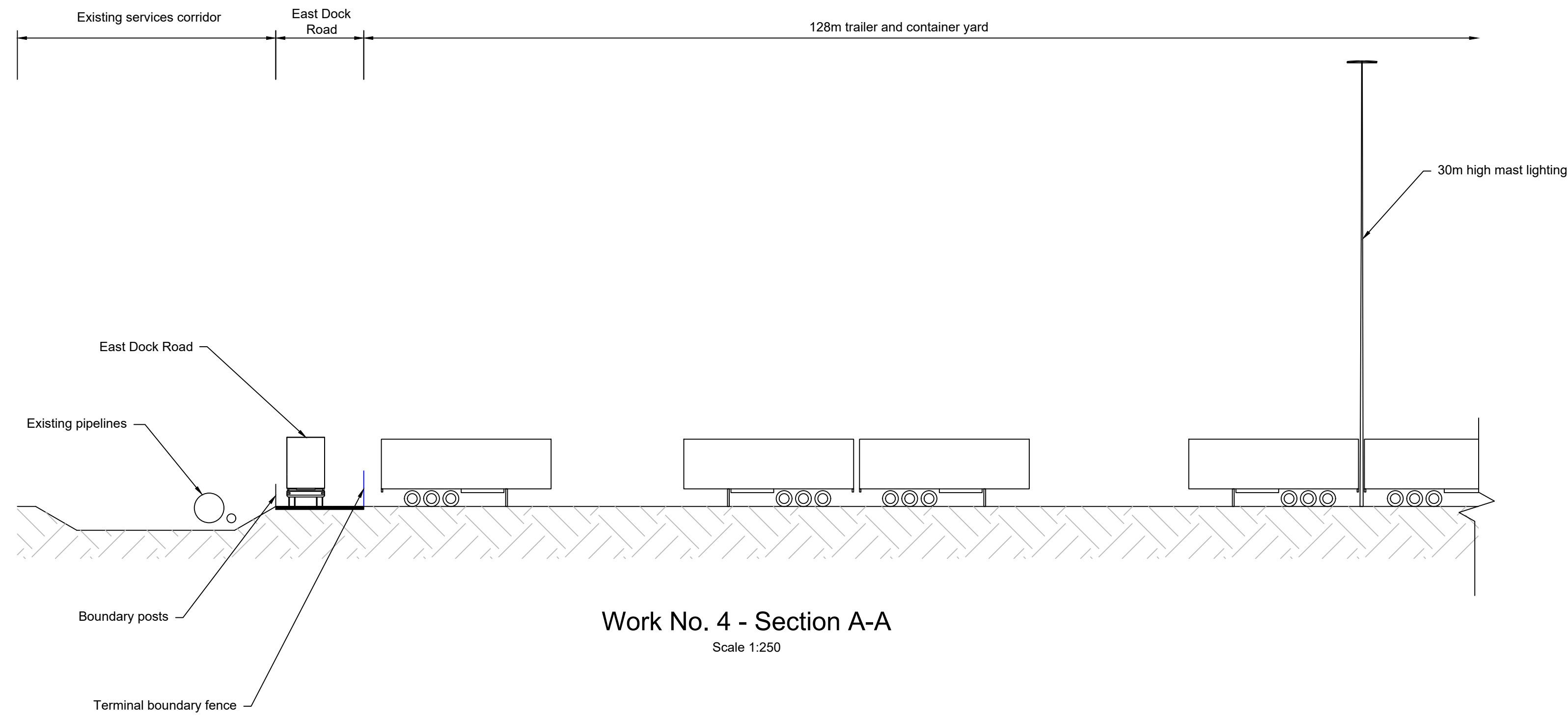

Work No. 4 - Section A-A
Scale 1:250

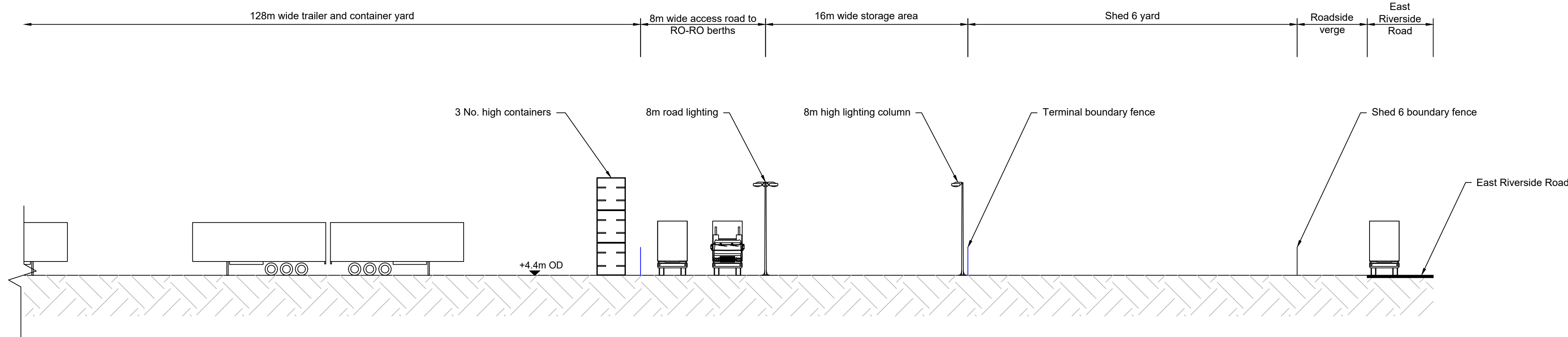

Work No. 4 - Section A-A (Cont.)
Scale 1:250

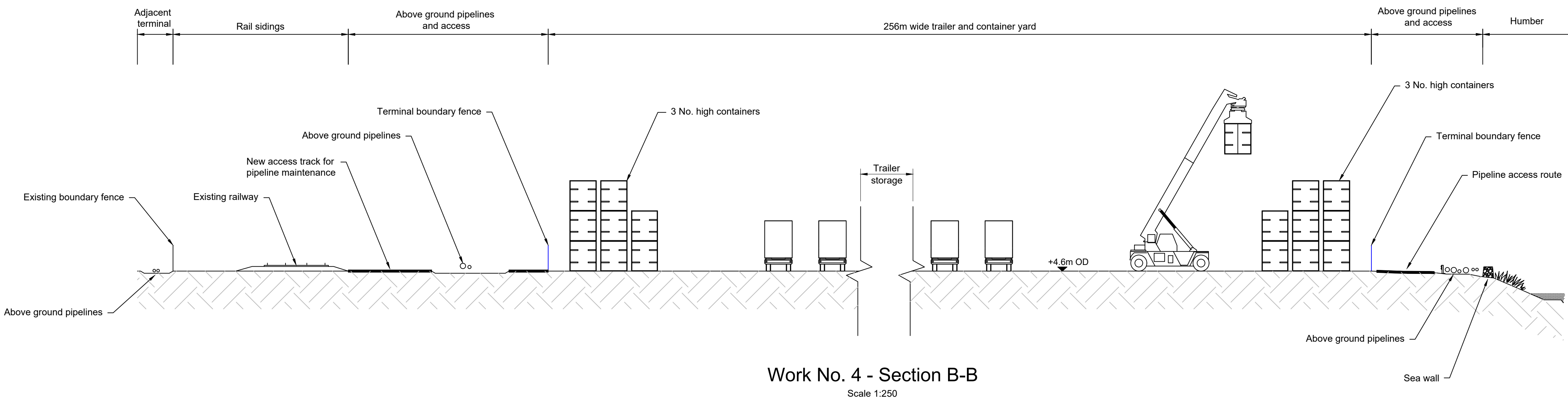

Work No. 4 - Section B-B
Scale 1:250

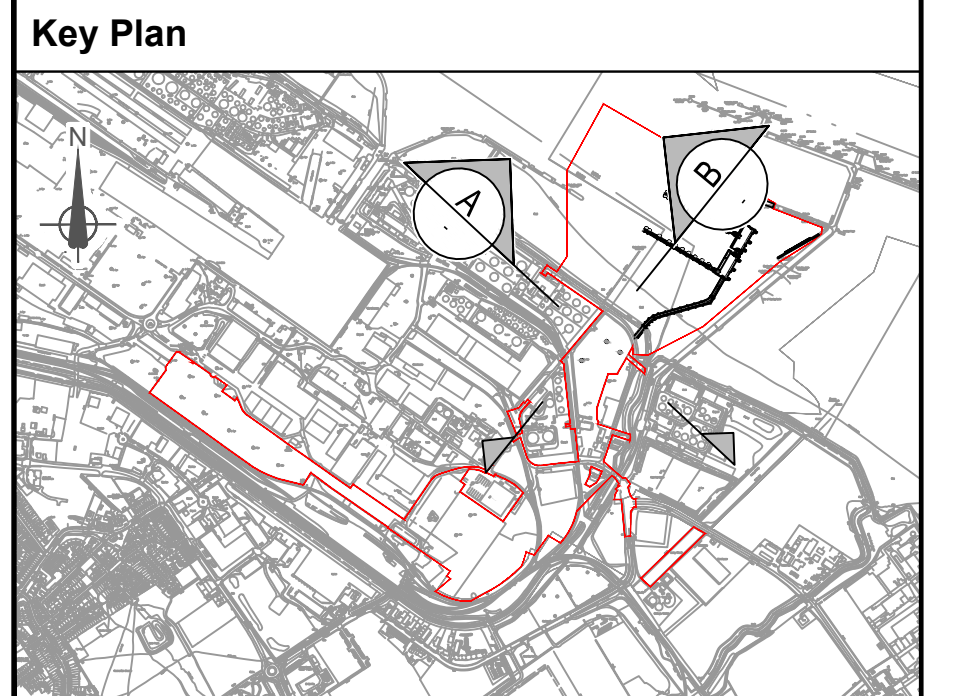

- General Notes**
- All dimensions are in millimetres unless stated otherwise.
 - These engineering sections and plans should be read in conjunction with the key plan and alongside other plans in the development consent order application, in particular the works plans and schedule 1 (authorised development) to the development consent order.
 - Work No. references are detailed in schedule 1 (authorised development) to the development consent order.
 - These engineering sections and plans will be subject to detailed design development; and changes will be limited to being within the order limits and any other constraints included in the development consent order.
 - Location of proposed infrastructure shown indicatively.
 - Levels shown on sections are typical for that location.
 - Building heights are based on height above surrounding finished paving levels.

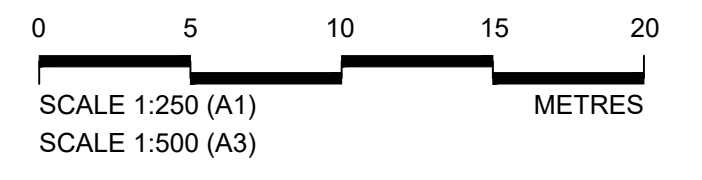

P05	November 2023	Changes Application Version	TH	RH	RH	CN
P04	October 2023	For Consultation	AE	RH	RH	CN
P03.1	September 2023	Deadline 4 submission	DT	RH	RH	CN
P03	March 2023	Sections amended per PINs Advice Note (dated 6 March 2023)	DT	ID	RH	CN
P02	February 2023	Submission Version	AJM	RH	RH	CN
P01	January 2023	Submission Version	AJM	RH	RH	CN
Rev	Rev. Date	Purpose of revision	Orig	Check	Rev	Apprv

Jacobs
95 Bothwell St, Glasgow, G2 7HX
Tel: +44(0)141 243 8000 Fax: +44(0)141 226 3109
www.jacobs.com

Client
ABP | ASSOCIATED BRITISH PORTS

Project
IMMINGHAM EASTERN RO-RO TERMINAL

Drawing title
ENGINEERING SECTIONS & PLANS ILLUSTRATIVE CROSS SECTIONS TRAILER AND CONTAINER PARK REGULATION 5(2)(c)

Drawing status
CHANGES APPLICATION VERSION Suitability **S4**

Scale
AS SHOWN @ A1

Jacobs No. B2429400 Rev P05
Client No.

Drawing number
B2429400-JAC-00-ZZ-DR-ZZ-0740

© Copyright 2022 Jacobs U.K. Limited. The concepts and information contained in this document are the property of Jacobs. Use or copying of this document in whole or in part without the written permission of Jacobs constitutes an infringement of copyright. Limitation: This drawing has been prepared on behalf of, and for the exclusive use of, the Client, and is subject to, and issued in accordance with, the provisions of the contract between Jacobs and the Client. Jacobs accepts no liability or responsibility whatsoever for, or in respect of, any use of, or reliance upon, this drawing by any third party.

\\ukfspp02\Maritime\PROJECTS\Ports(VT)\B2429400-ABP-Project\Sugar\1100-Design & Engineering\1102-Drawings\01-Preliminary\02-DCO Drawings\B2429400-JAC-00-ZZ-DR-ZZ-0741-P05.dwg - 27/11/2023 11:03:47 - 0741 - HillsRJ

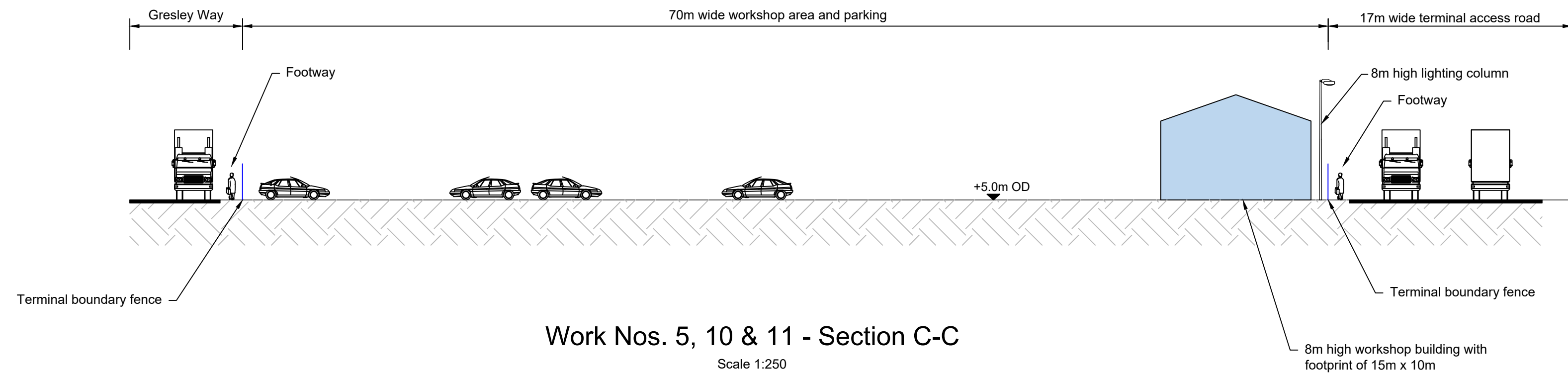

Work Nos. 5, 10 & 11 - Section C-C
Scale 1:250

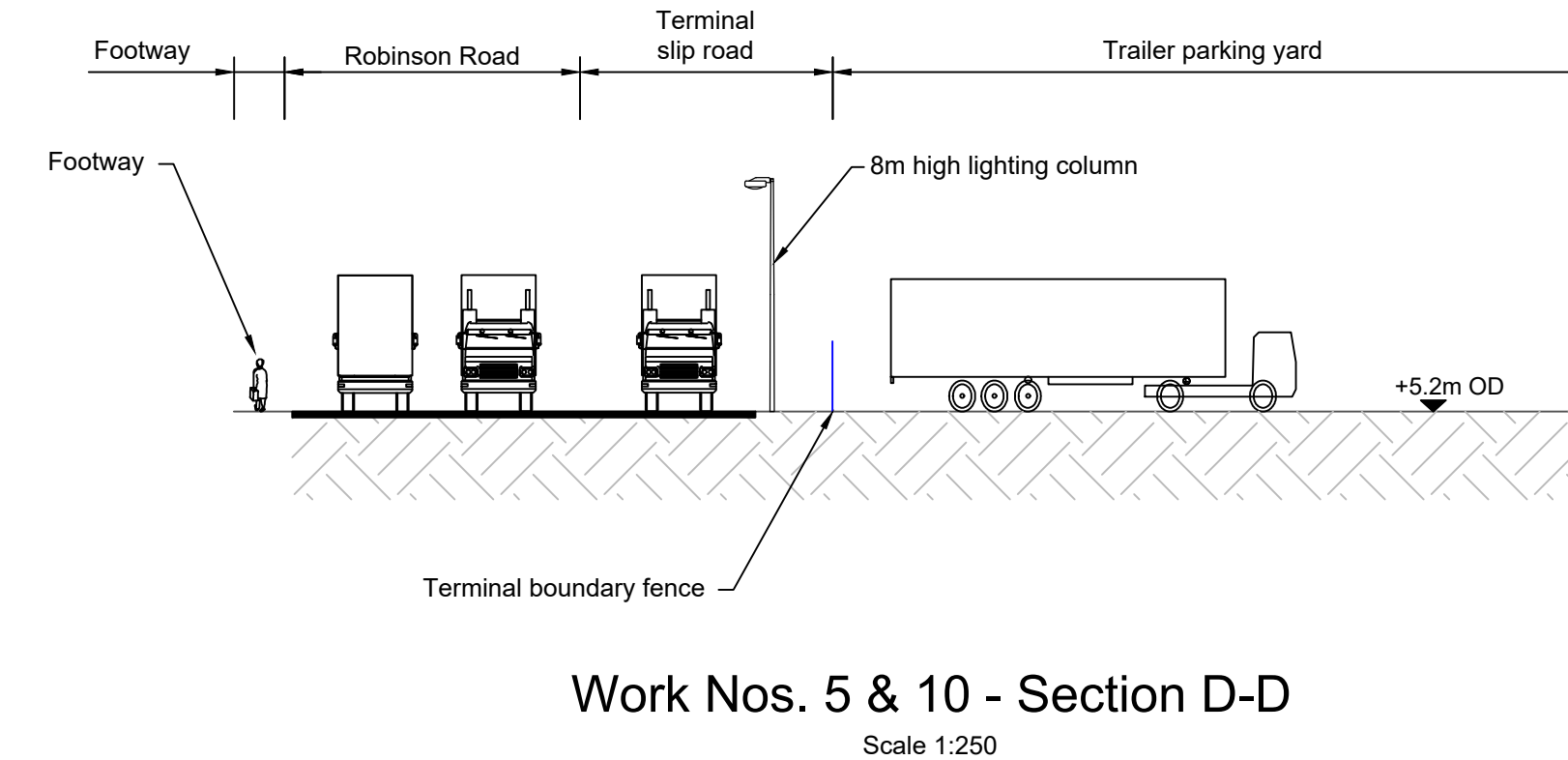

Work Nos. 5 & 10 - Section D-D
Scale 1:250

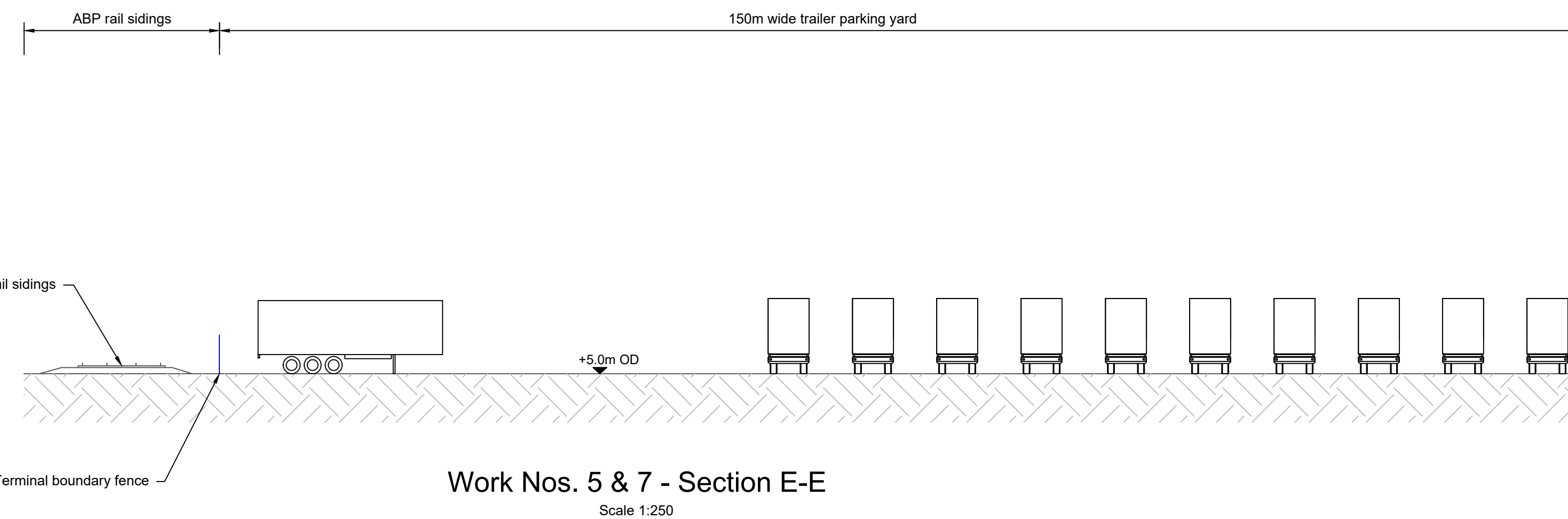

Work Nos. 5 & 7 - Section E-E
Scale 1:250

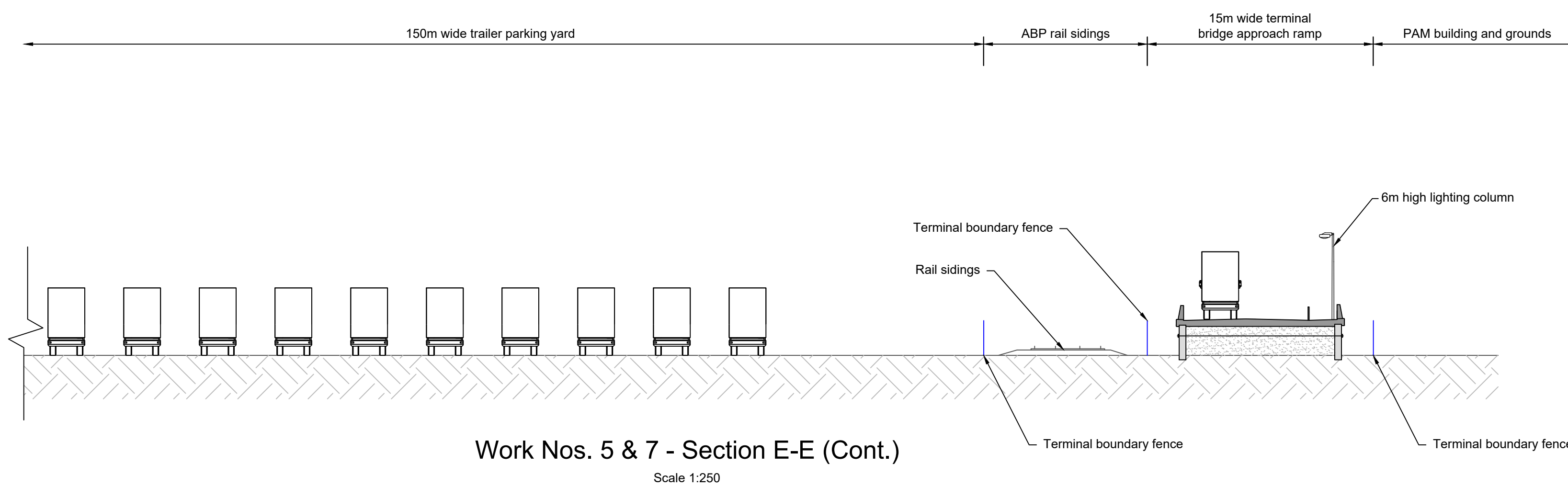

Work Nos. 5 & 7 - Section E-E (Cont.)
Scale 1:250

Key Plan

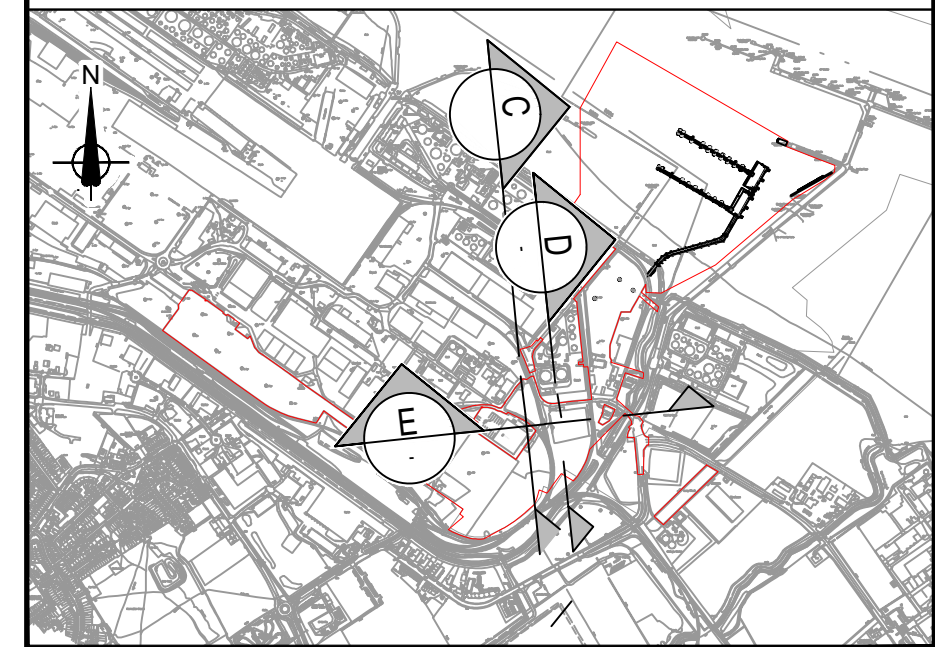

General Notes

- All dimensions are in millimetres unless stated otherwise.
- These engineering sections and plans should be read in conjunction with the key plan and alongside other plans in the development consent order application, in particular the works plans and schedule 1 (authorised development) to the development consent order.
- Work no. references are detailed in schedule 1 (authorised development) to the development consent order.
- These engineering sections and plans will be subject to detailed design development; and changes will be limited to being within the order limits and any other constraints included in the development consent order.
- Location of proposed infrastructure shown indicatively.
- Levels shown on sections are typical for that location.
- Building heights are based on height above surrounding finished paving levels.

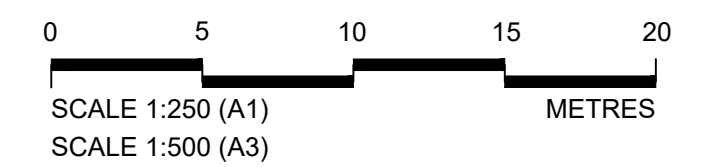

Rev	Rev. Date	Purpose of revision	Orig	Check	Rev	Apprv
P05	November 2023	Changes Application Version	TH	RH	RH	CN
P04	October 2023	For Consultation	AE	RH	RH	CN
P03.1	September 2023	Deadline 4 submission	DT	RH	RH	CN
P03	March 2023	Sections amended per PINS Advice Note (dated 6 March 2023)	DT	ID	RH	CN
P02	February 2023	Submission Version	AJM	RH	RH	CN
P01	January 2023	Submission Version	AJM	RH	RH	CN

Jacobs

95 Bothwell St, Glasgow, G2 7HX
Tel: +44(0)141 243 8000 Fax: +44(0)141 226 3109
www.jacobs.com

Client
ABP ASSOCIATED BRITISH PORTS

Project
IMMINGHAM EASTERN RO-RO TERMINAL

Drawing title
ENGINEERING SECTIONS & PLANS ILLUSTRATIVE CROSS SECTIONS TRAILER PARK & WORKSHOP AREA REGULATION 5(2)(o)

Drawing status	CHANGES APPLICATION VERSION	Suitability	S4
Scale	AS SHOWN @ A1		
Jacobs No.	B2429400	Rev	P05
Client No.			

Drawing number
B2429400-JAC-00-ZZ-DR-ZZ-0741

© Copyright 2022 Jacobs U.K. Limited. The concepts and information contained in this document are the property of Jacobs. Use or copying of this document in whole or in part without the written permission of Jacobs constitutes an infringement of copyright. Limitation: This drawing has been prepared on behalf of, and for the exclusive use of, Jacobs' Client, and is subject to, and issued in accordance with, the provisions of the contract between Jacobs and the Client. Jacobs accepts no liability or responsibility whatsoever for, or in respect of, any use of, or reliance upon, this drawing by any third party.

\\ukfspp02\maritime\PROJECTS\Ports(VT)\B2429400-ABP-Project\Sugar\1100-Design & Engineering\1102-Drawings\01-Preliminary\02-DCO Drawings\B2429400-JAC-00-ZZ-DR-ZZ-0742-P05.dwg - 24/11/2023 17:01:08 - 0742 - HodgeT

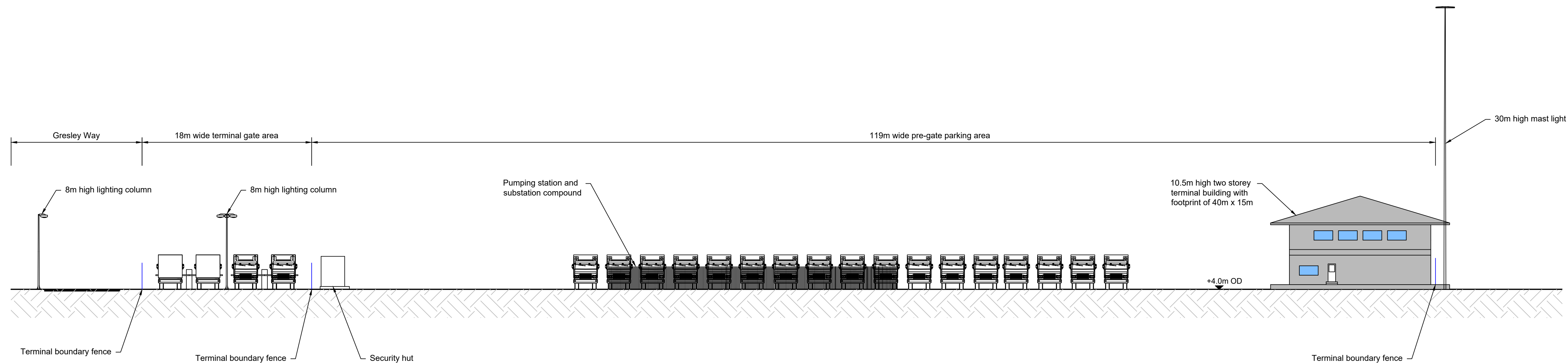

Work No. 5 - Section F-F
Scale 1:250

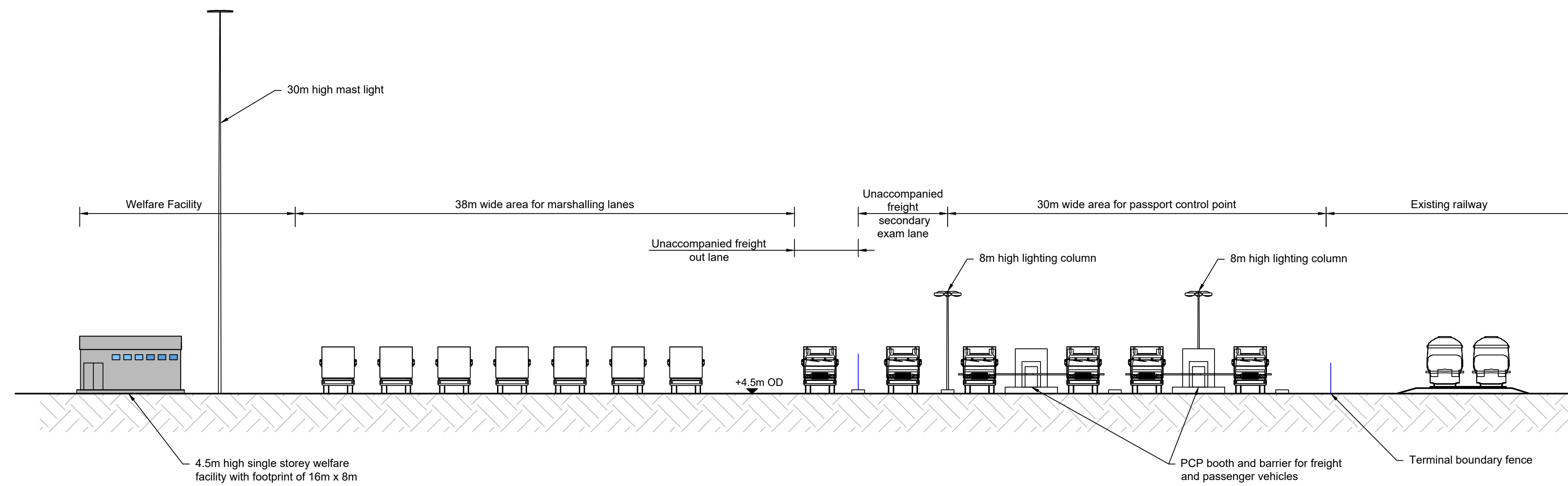

Work No. 5 - Section G-G
Scale 1:250

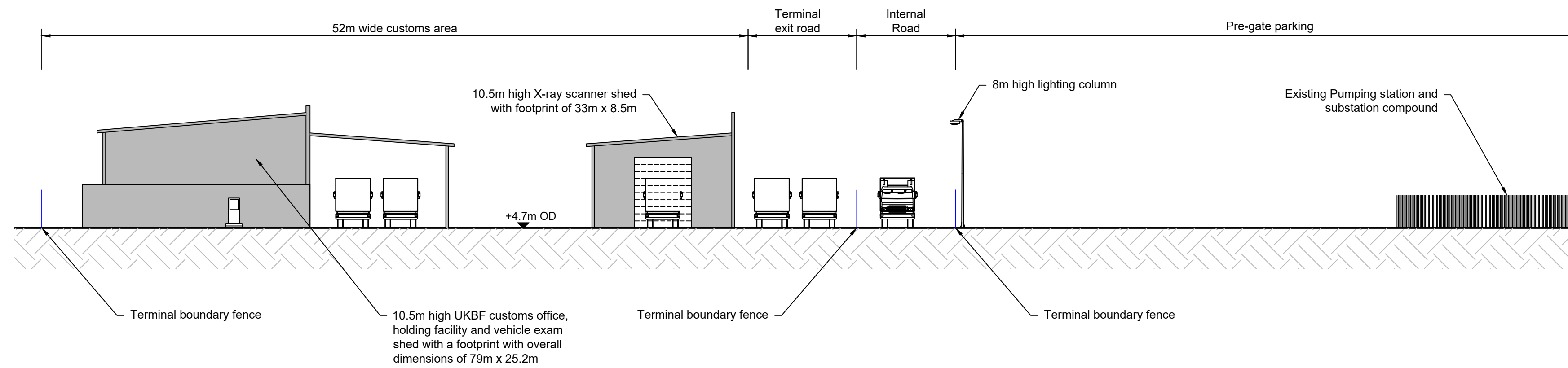

Work No. 5 - Section J-J
Scale 1:250

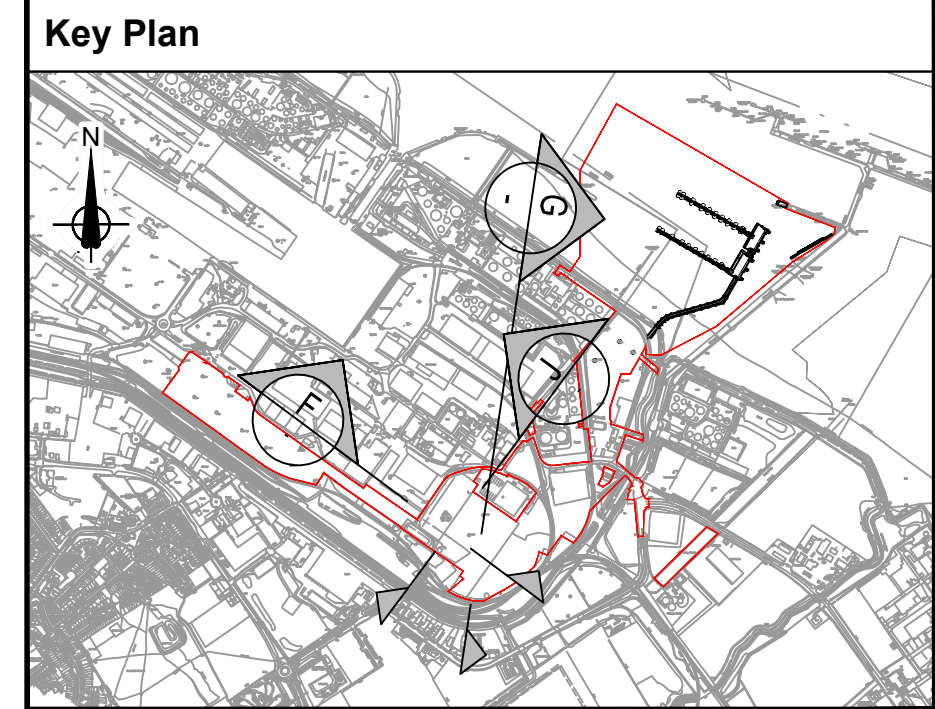

- General Notes**
- All dimensions are in millimetres unless stated otherwise.
 - These engineering sections and plans should be read in conjunction with the key plan and alongside other plans in the development consent order application, in particular the works plans and schedule 1 (authorised development) to the development consent order.
 - Work No. references are detailed in schedule 1 (authorised development) to the development consent order.
 - These engineering sections and plans will be subject to detailed design development; and changes will be limited to being within the order limits and any other constraints included in the development consent order.
 - Location of proposed infrastructure shown indicatively.
 - Levels shown on sections are typical for that location.
 - Building heights are based on height above surrounding finished paving levels.

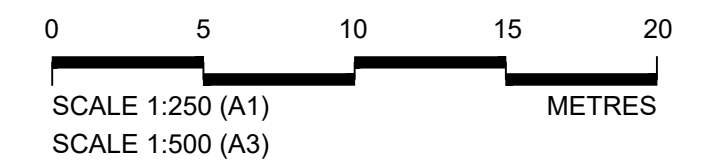

Rev	Rev. Date	Purpose of revision	Orig	Check	Rev	Apprv
P05	November 2023	Changes Application Version	TH	RH	RH	CN
P04	October 2023	For Consultation	AE	RH	RH	CN
P03.1	September 2023	Deadline 4 submission	DT	RH	RH	CN
P03	March 2023	Sections amended per PINs Advice Note (dated 6 March 2023)	DT	ID	RH	CN
P02	February 2023	Submission Version	AJM	RH	RH	CN
P01	January 2023	Submission Version	AJM	RH	RH	CN

Jacobs

95 Bothwell St, Glasgow, G2 7HX
Tel: +44(0)141 243 8000 Fax: +44(0)141 226 3109
www.jacobs.com

Client: **ABP ASSOCIATED BRITISH PORTS**

Project: **IMMINGHAM EASTERN RO-RO TERMINAL**

Drawing title: **ENGINEERING SECTIONS & PLANS ILLUSTRATIVE CROSS SECTIONS PRE-GATE AND TRAILER PARK REGULATION 5(2)(o)**

Drawing status: **CHANGES APPLICATION VERSION** Suitability: **S4**

Scale: **AS SHOWN @ A1**

Jacobs No.: **B2429400** Rev: **P05**

Client No.: **B2429400**

Drawing number: **B2429400-JAC-00-ZZ-DR-ZZ-0742**

© Copyright 2023 Jacobs U.K. Limited. The concepts and information contained in this document are the property of Jacobs. Use or copying of this document in whole or in part without the written permission of Jacobs constitutes an infringement of copyright. Limitation: This drawing has been prepared on behalf of, and for the exclusive use of, the Client. Jacobs accepts no liability or responsibility whatsoever for, or in respect of, any use of, or reliance upon, this drawing by any third party.

\\uksp02\maritime\PROJECTS\Ports\VT\B2429400-ABP-Project\Sugar\1100 Design & Engineering\1102 Drawings\01 Preliminary\02 DCO Drawings\B2429400-JAC-00-ZZ-DR-ZZ-0743 P05.dwg - 24/11/2023 17:04:01 - 0743 - HodgeT

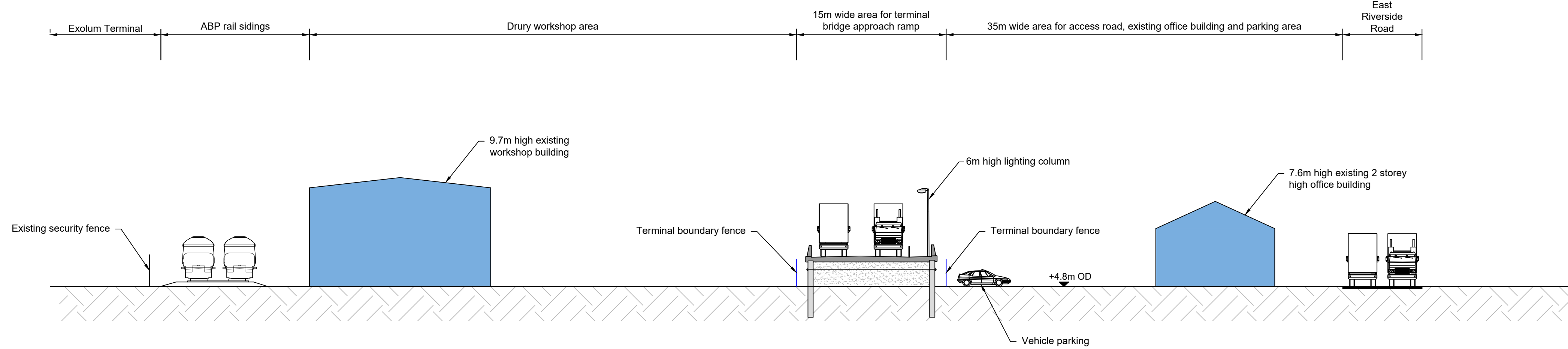

Work Nos. 4 & 7 - Section K-K
Scale 1:250

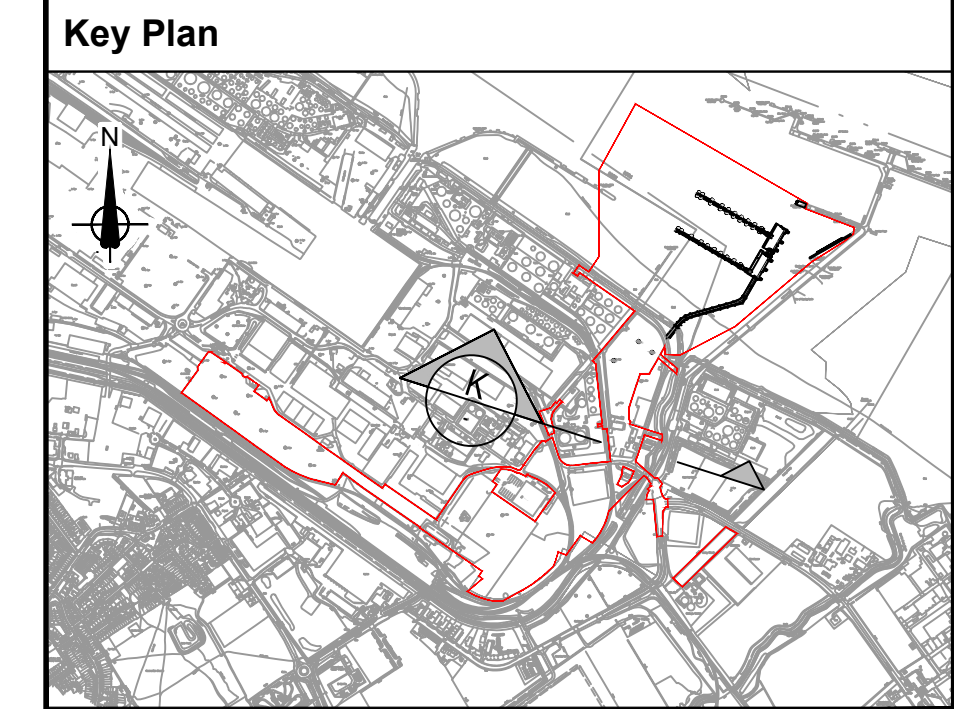

- General Notes**
- All dimensions are in millimetres unless stated otherwise.
 - These engineering sections and plans should be read in conjunction with the key plan and alongside other plans in the development consent order application, in particular the works plans and schedule 1 (authorised development) to the development consent order.
 - Work No. references are detailed in schedule 1 (authorised development) to the development consent order.
 - These engineering sections and plans will be subject to detailed design development; and changes will be limited to being within the order limits and any other constraints included in the development consent order.
 - Location of proposed infrastructure shown indicatively.
 - Levels shown on sections are typical for that location.
 - Building heights are based on height above surrounding finished paving levels.

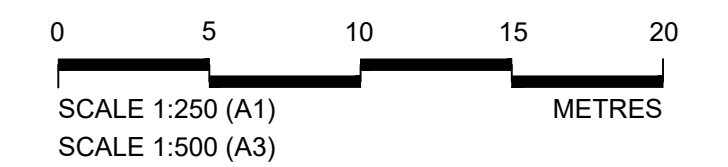

Rev	Rev. Date	Purpose of revision	Orig	Check	Rev	Apprv
P05	November 2023	Changes Application Version	TH	RH	RH	CN
P04	October 2023	For Consultation	AE	RH	RH	CN
P03	August 2023	Client review	DT	ID	RH	CN
P02.1	September 2023	Deadline 4 submission	DT	RH	RH	CN
P02	February 2023	Submission Version	AJM	RH	RH	CN
P01	January 2023	Submission Version	AJM	RH	RH	CN

Jacobs
95 Bothwell St, Glasgow, G2 7HX
Tel: +44(0)141 243 8000 Fax: +44(0)141 226 3109
www.jacobs.com

Client
ABP ASSOCIATED BRITISH PORTS

Project
IMMINGHAM EASTERN
RO-RO TERMINAL

Drawing title
**ENGINEERING SECTIONS & PLANS
ILLUSTRATIVE CROSS SECTIONS
DRURY AREA
REGULATION 5(2)(o)**

Drawing status	CHANGES APPLICATION VERSION	Suitability	S4
Scale	AS SHOWN @ A1		
Jacobs No.	B2429400	Rev	P05
Client No.			
Drawing number	B2429400-JAC-00-ZZ-DR-ZZ-0743		

© Copyright 2022 Jacobs U.K. Limited. The concepts and information contained in this document are the property of Jacobs. Use or copying of this document in whole or in part without the written permission of Jacobs constitutes an infringement of copyright. Limitation: This drawing has been prepared on behalf of, and for the exclusive use of, Jacobs' Client, and is subject to, and issued in accordance with, the provisions of the contract between Jacobs and the Client. Jacobs accepts no liability or responsibility whatsoever for, or in respect of, any use of, or reliance upon, this drawing by any third party.

\\ukfspp02\Maritime\PROJECTS\Ports\VT\B2429400-ABP-Project\Sugar\1100 Design & Engineering\1102 Drawings\01 Preliminary\02 DCO Drawings\B2429400-JAC-00-ZZ-DR-ZZ-0750 P05.dwg - 27/11/2023 16:48:12 - Bridge GA - HillerJ

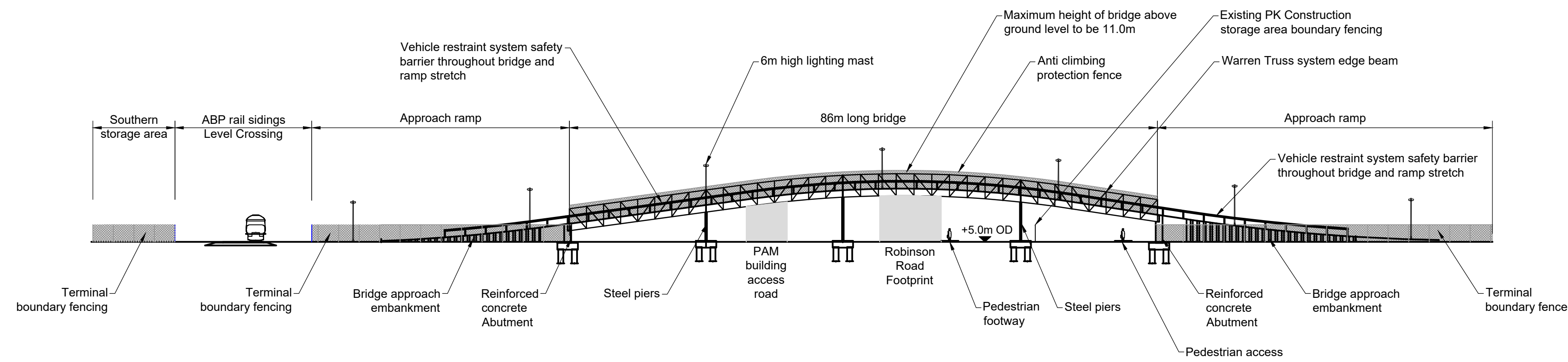

Work No. 5 and 7 - Section H-H
Scale 1:500

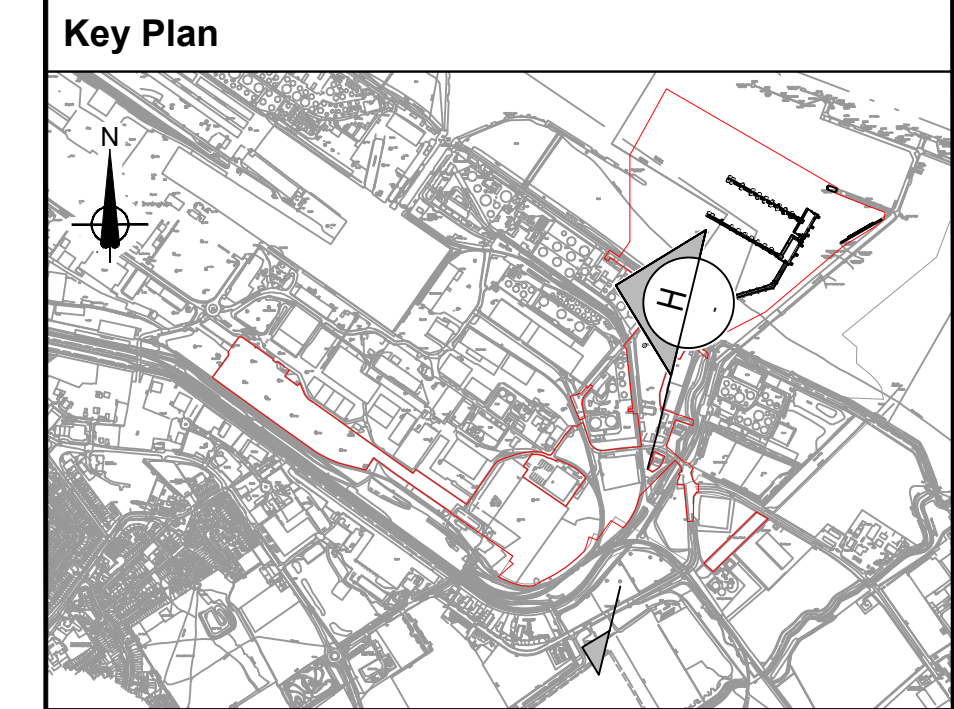

- Notes
- All dimensions are in millimetres unless stated otherwise.
 - These Engineering sections and plans should be read in conjunction with the key plan and alongside other plans in the development consent order application. In particular the works plans and schedule 1 (Authorised development) to the development consent order.
 - Work No. references are detailed in schedule 1 (authorised development) to the development consent order.
 - These engineering sections and plans will be subject to detailed design development, and changes will be limited to being within the order limit and any other constraints included in the development consent order.
 - Location of proposed infrastructure shown indicatively
 - The levels shown are existing levels for Robinson Road and are typical for that location.
 - Building heights are based on height above surrounding finished paving levels.

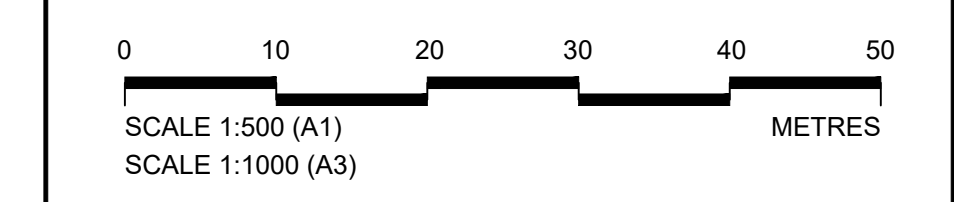

Rev	Rev. Date	Purpose of revision	Orig	Check	Rev	Apprv
P05	November 2023	Changes Application Version	TH	RH	RH	CN
P04	October 2023	For Consultation	AE	RH	RH	CN
P03	August 2023	Client review	DT	ID	RH	CN
P02.1	September 2023	Deadline 4 submission	DT	RH	RH	CN
P02	February 2023	Submission Version	BHW	RH	RH	CN
P01	January 2023	Submission Version	BHW	RH	RH	CN

Jacobs
95 Bothwell St, Glasgow, G2 7HX
Tel: +44(0)141 243 8000 Fax: +44(0)141 226 3109
www.jacobs.com

Client
ABP ASSOCIATED BRITISH PORTS

Project
IMMINGHAM EASTERN RO-RO TERMINAL

Drawing title
ENGINEERING SECTIONS & PLANS ILLUSTRATIVE CROSS SECTIONS ROBINSON ROAD BRIDGE REGULATION 5(2)(o)

Drawing status	CHANGES APPLICATION VERSION	Suitability	S4
Scale	1:500 @ A1		
Jacobs No.	B2429400	Rev	P05
Client No.			
Drawing number	B2429400-JAC-00-ZZ-DR-ZZ-0750		

© Copyright 2022 Jacobs U.K. Limited. The concepts and information contained in this document are the property of Jacobs. Use or copying of this document in whole or in part without the written permission of Jacobs constitutes an infringement of copyright. Limitation: This drawing has been prepared on behalf of, and for the exclusive use of, the Client. Jacobs accepts no liability or responsibility whatsoever for, or in respect of, any use of, or reliance upon, this drawing by any third party.

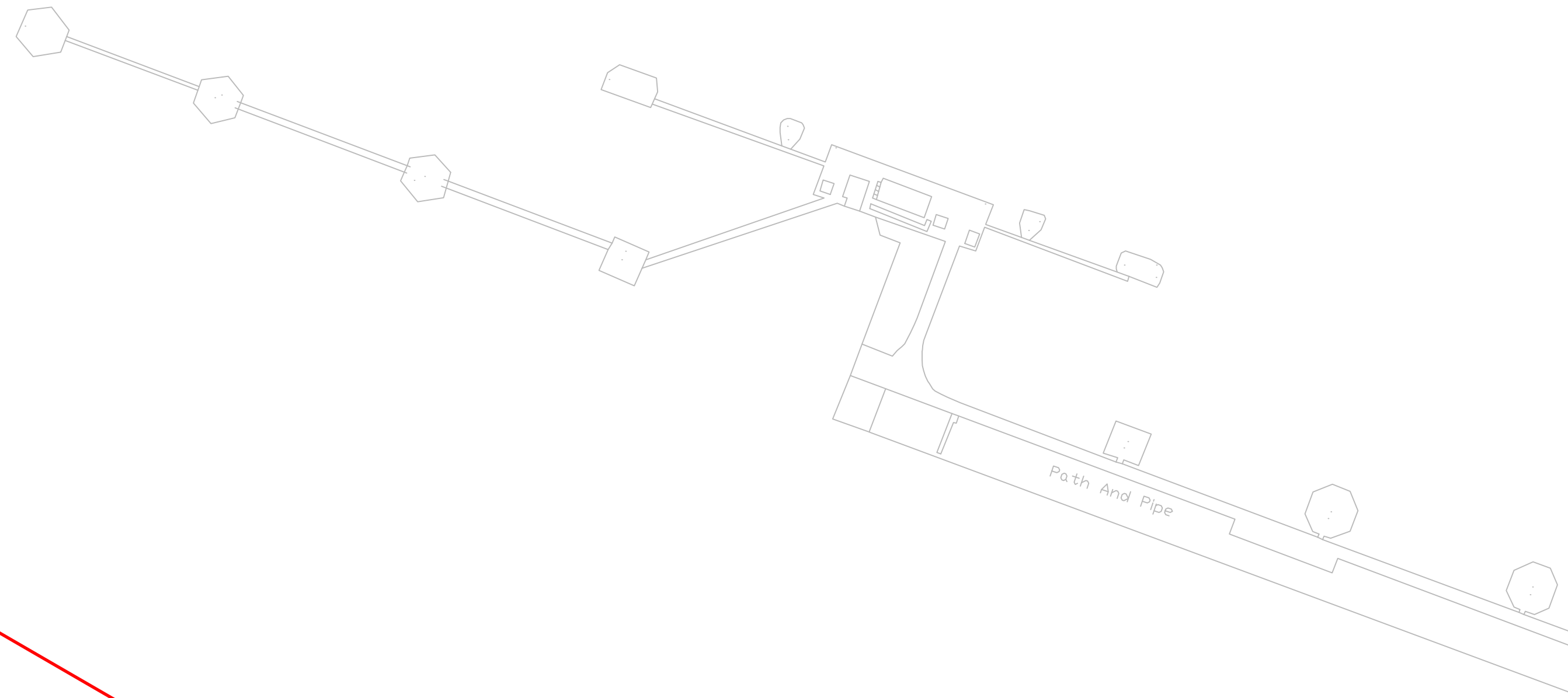
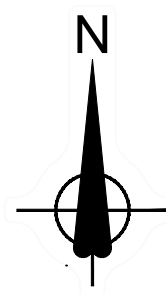

Existing fender piles (2No.) and donut fenders to be removed.

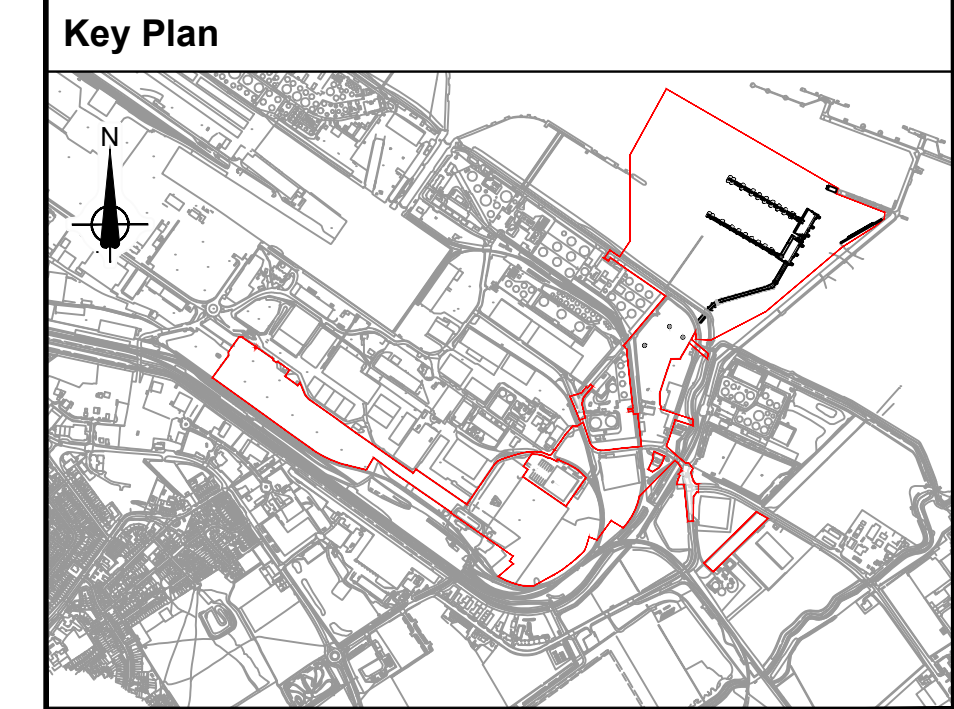

General Notes

1. All dimensions are in millimetres unless stated otherwise.
2. These Engineering sections and plans should be read in conjunction with the key plan and alongside other plans in the Development Consent Order application, in particular the works plans and Schedule 1 (authorised development) to the Development Consent Order.
3. Work No. references are detailed in Schedule 1 (Authorised Development) to the Development Consent Order.
4. These Engineering sections and plans will be subject to detailed design development; and changes will be limited to being within the Order Limits and any other constraints included in the Development Consent Order.
5. Location of proposed infrastructure shown indicatively.

Legend

- Order Limits
- Buildings to be demolished

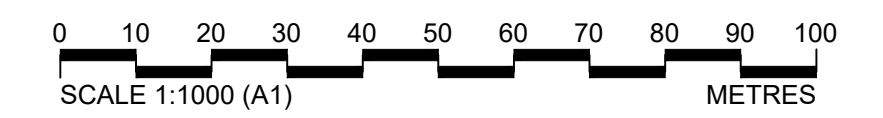

P03	November 2023	Changes Application Version	TH	RH	RH	CN
P02	October 2023	For Consultation	AE	RH	RH	CN
P01	October 2023	Client review	AE	RH	RH	CN
Rev	Rev. Date	Purpose of revision	Orig	Check	Rev	Apprv

Jacobs

95 Bothwell St, Glasgow, G2 7HX
Tel: +44(0)141 243 8000 Fax: +44(0)141 226 3109
www.jacobs.com



Client
**IMMINGHAM EASTERN
RO-RO TERMINAL**

Drawing title
**ENGINEERING SECTIONS & PLANS
DEMOLITION WORKS
REGULATION 5(2)(o)
SHEET 2 OF 2**

Drawing status	CHANGES APPLICATION VERSION	Suitability	S4
Scale	1:1250 @ A1		
Jacobs No.	B2429400		
Client No.			P03

Drawing number
B2429400-JAC-00-ZZ-DR-ZZ-0802

© Copyright 2022 Jacobs U.K. Limited. The concepts and information contained in this document are the property of Jacobs. Use or copying of this document in whole or in part without the written permission of Jacobs constitutes an infringement of copyright. Limitation: This drawing has been prepared on behalf of, and for the exclusive use of, Jacobs' Client, and is subject to, and issued in accordance with, the provisions of the contract between Jacobs and the Client. Jacobs accepts no liability or responsibility whatsoever for, or in respect of, any use of, or reliance upon, this drawing by any third party.

\\ukfsp02\maritime\PROJECTS\Ports\VT\B2429400-ABP-Project\Sugar\1100-Design & Engineering\1102-Drawings\01-Preliminary\02-DCO Drawings\B2429400-JAC-00-ZZ-DR-ZZ-0801-P05 and 0802-P03.dwg - 23/11/2023 09:35:27 - 0802 - HodgeT